

> Instructions

Thule ReVert bike repair holder 9020510

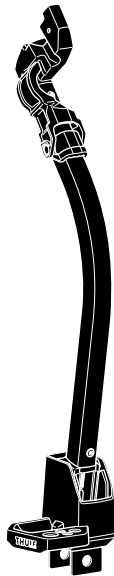

i

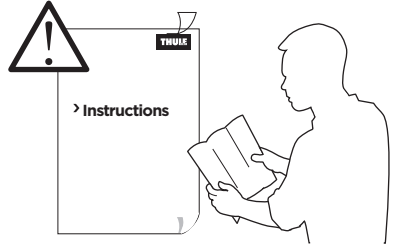
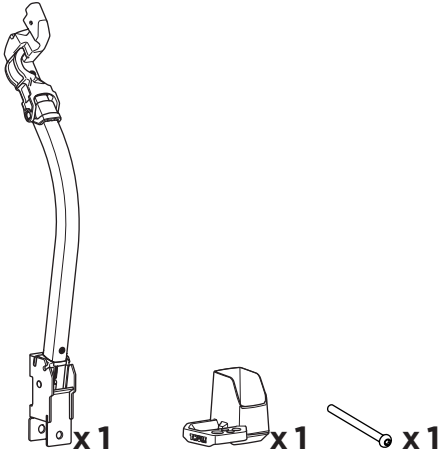

1

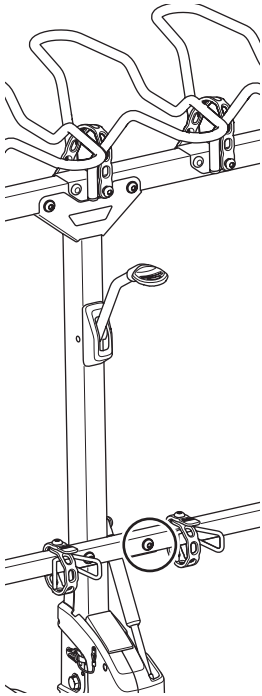

A

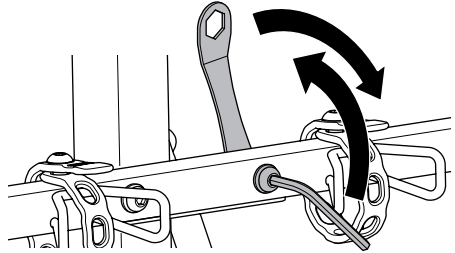

B

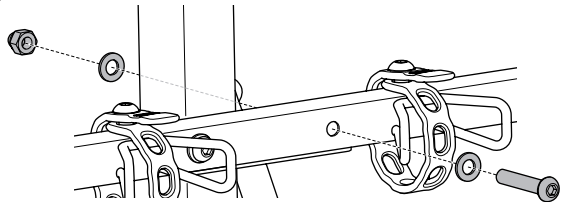

2

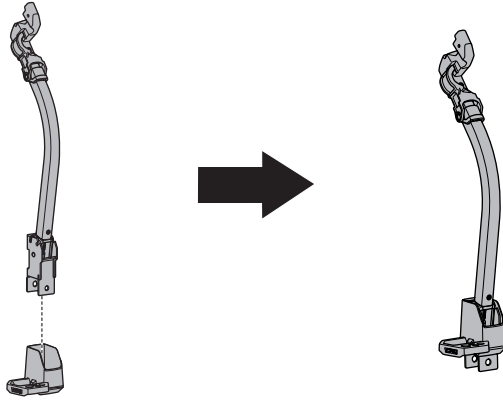

3

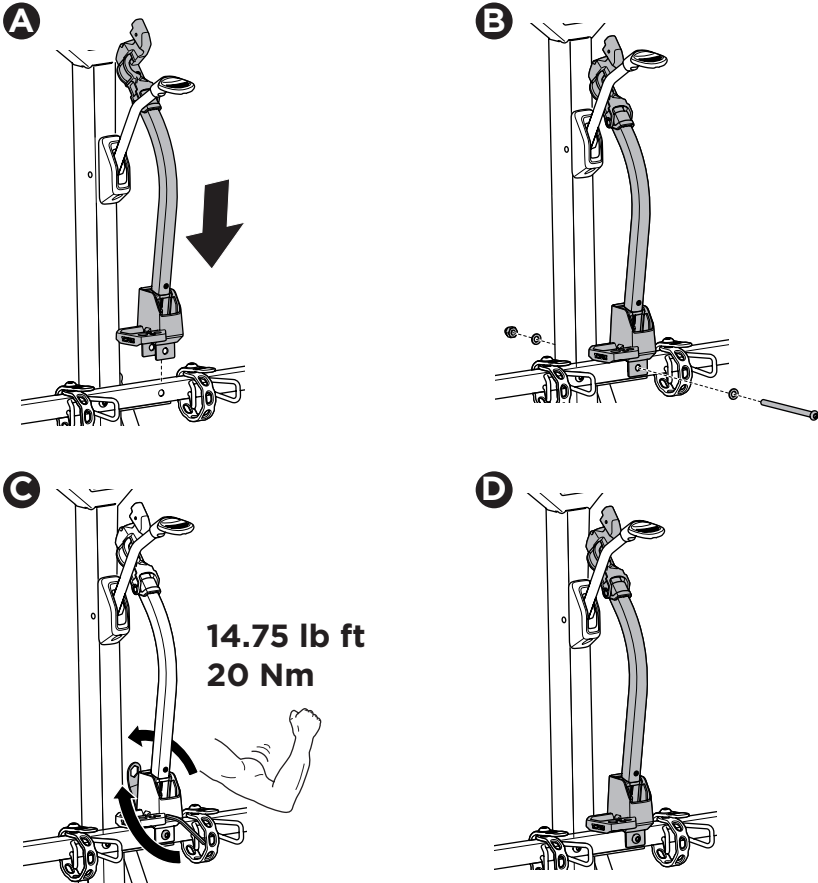

4

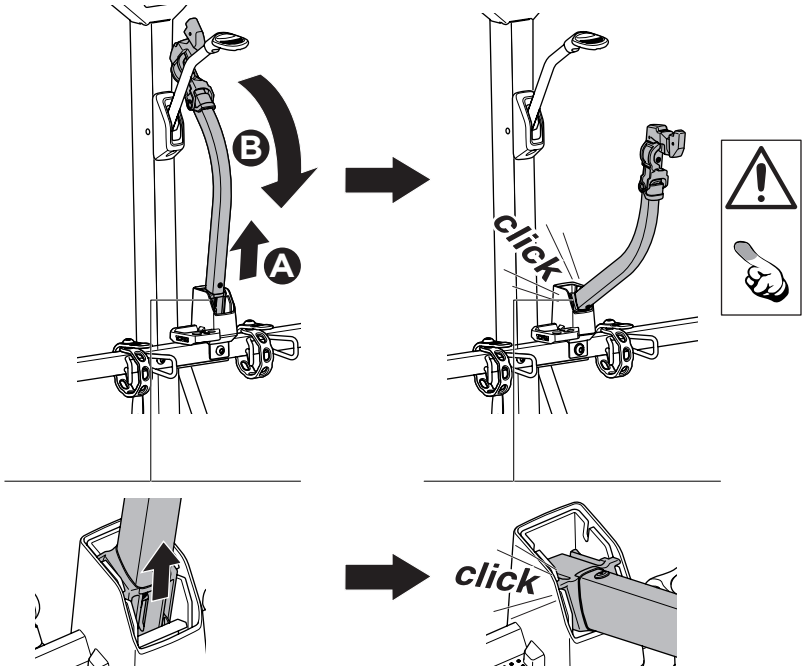

4

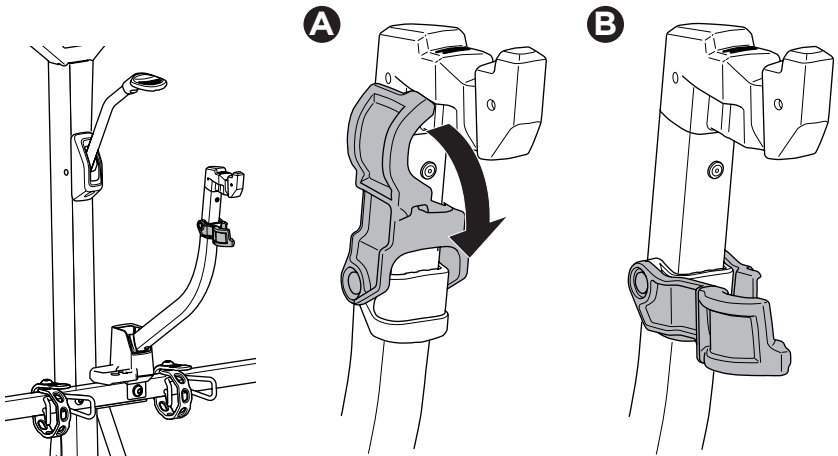

5

A

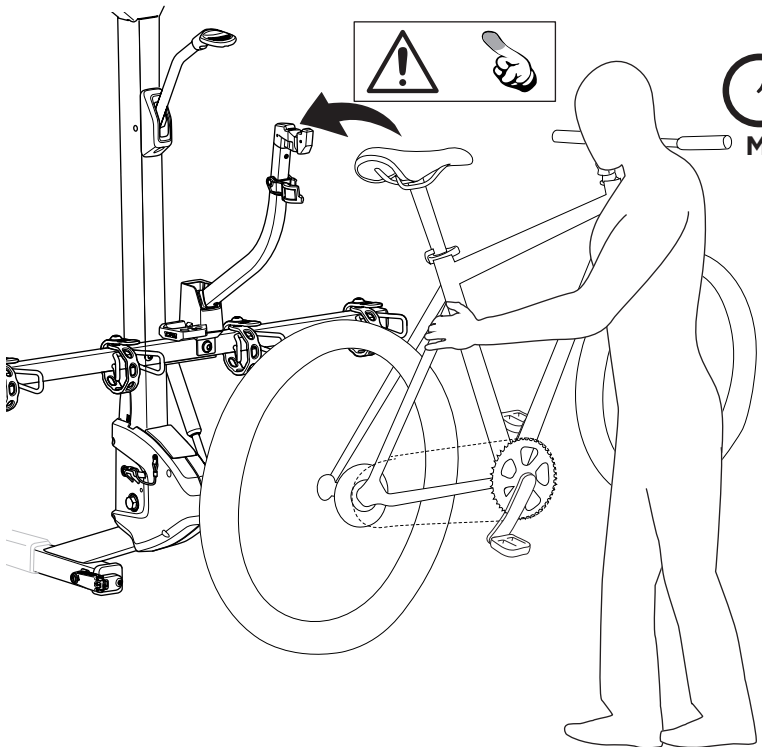

**Max 55 Lbs
(25 kg)**

B

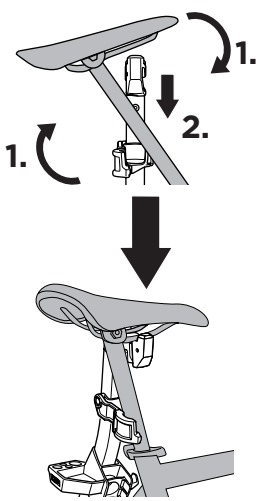
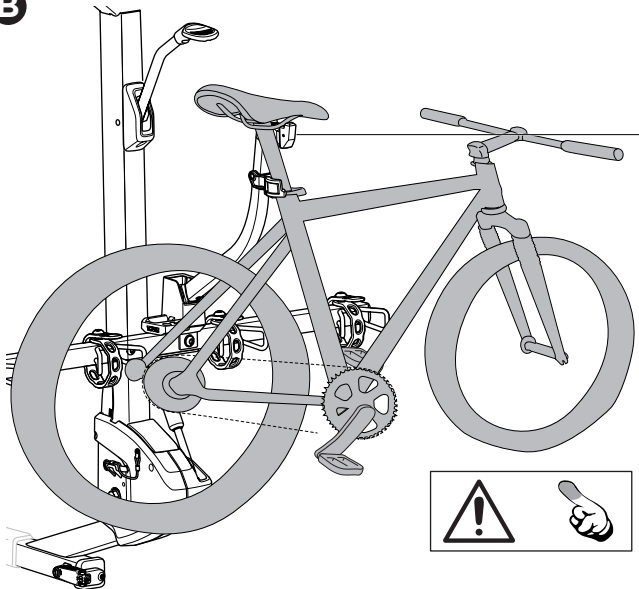

i

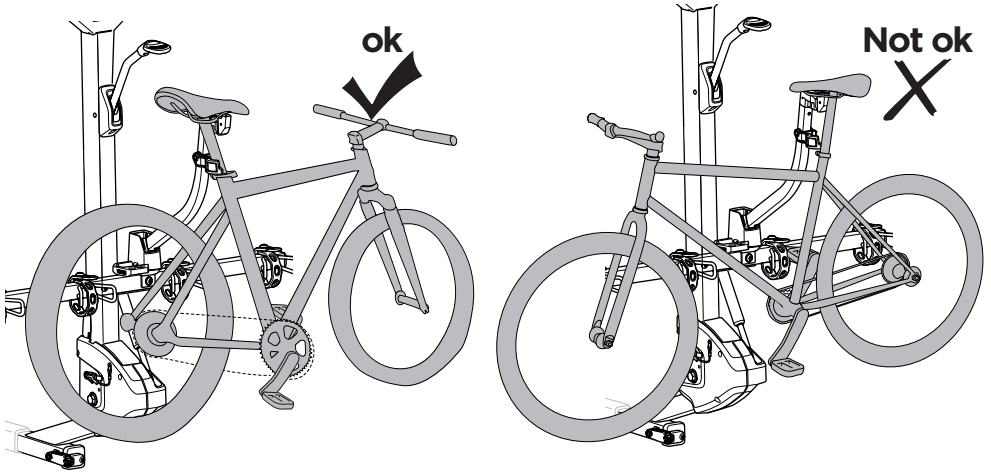

i

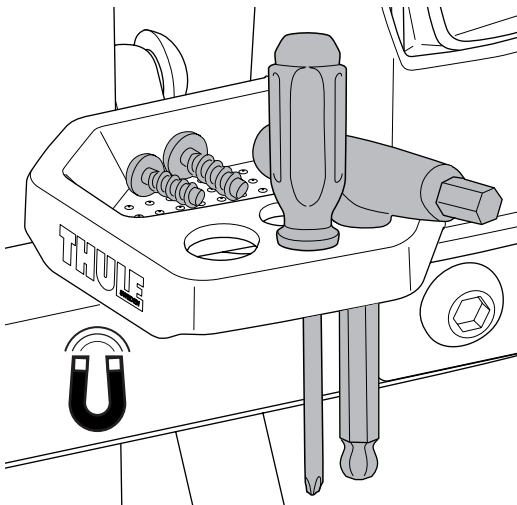

A

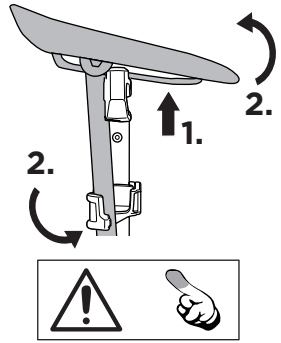
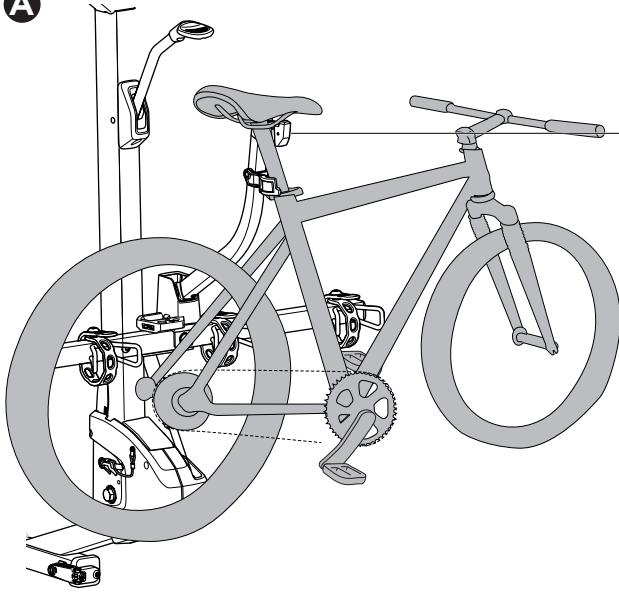

B

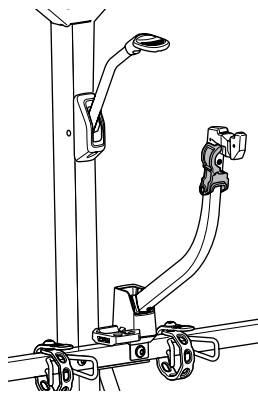

1.

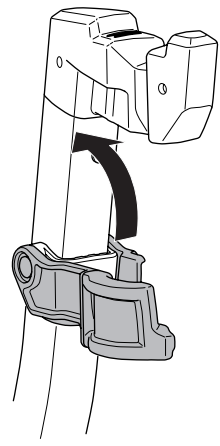

2.

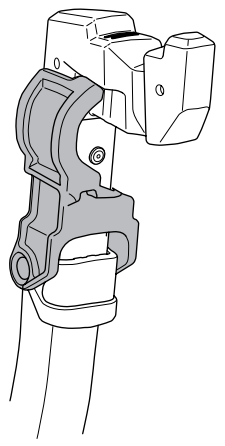

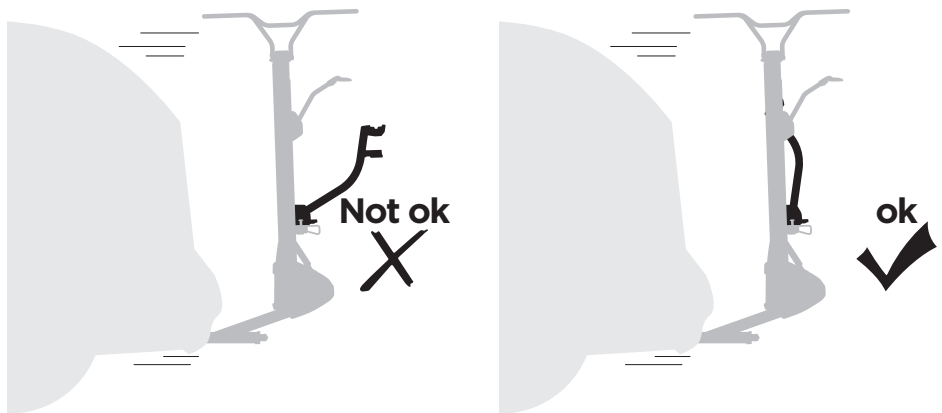
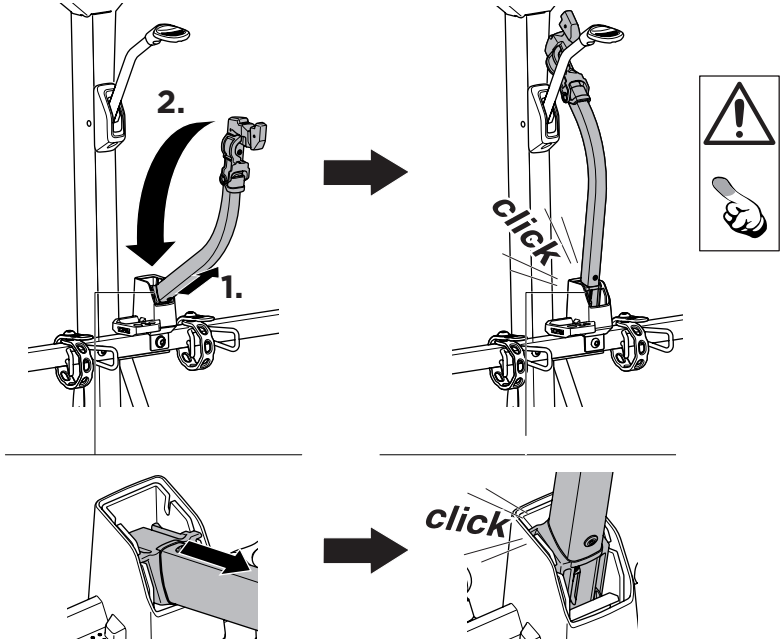
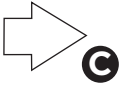

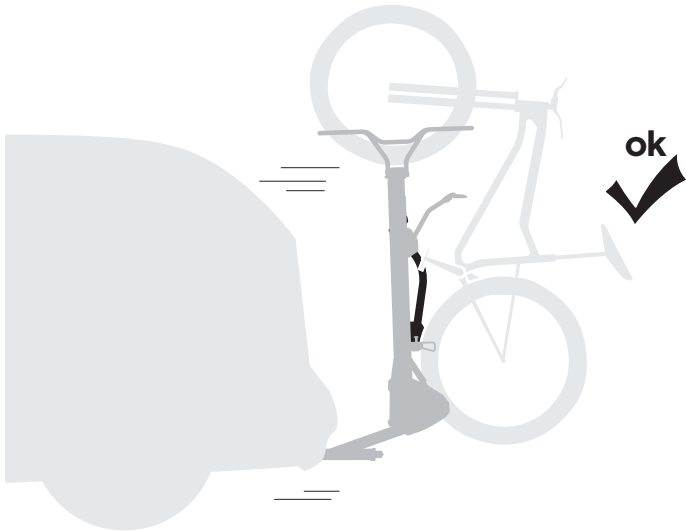
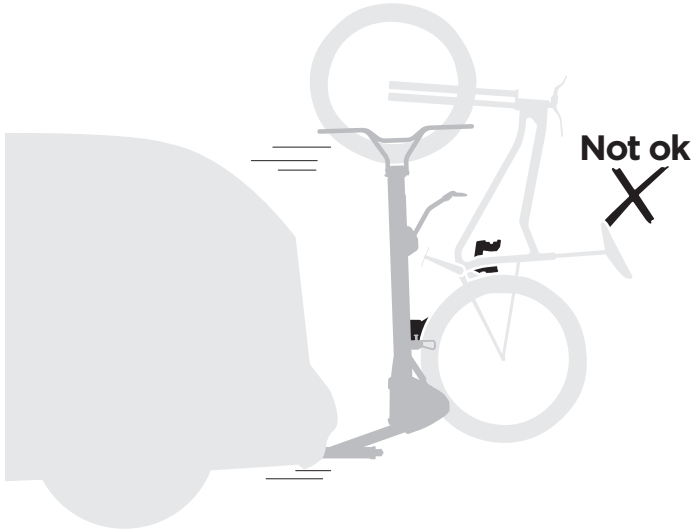



Thule Inc. • 42 Silvermine Road • Seymour, CT 06483

Thule Canada Inc. • 710 Bernard • Granby QC J2J 0H6

North American Consumer Service: Toll Free 800-238-2388 / Fax 450-777-3615 • www.thule.com

Register online at
www.thule.com/register