

Components and Hardware:

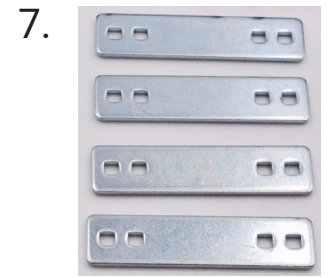
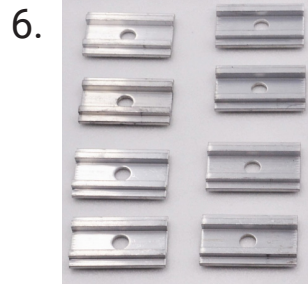

Components and Hardware:

1. GoTent w/ 5mm Foam Mattress	(1)	13. Tent Key.....	(1)
2. Rain Fly Bows.....	(2)	14. Open End Wrench.....	(1)
3. Ladder.....	(1)	15. Allen Key.....	(1)
4. Crossbars	(2)	16. Light Bar.....	(1)
5. Crossbar Mounting Brackets	(4)		
6. Small Bolt Plates.....	(8)		
7. Large Bolt Plates.....	(4)		
8. Socket Head Bolt M8 x 25mm	(8)		
9. Hex Head Bolt M8 x 50mm	(8)		
10. Locking Nut M8.....	(16)		
11. Button Head Bolt M8 x 14mm.....	(8)		
12. Square Nut M8	(8)		

GoTent

1. Tent includes Crossbars (#4) that install to the top of the tent. Before installing the tent, if you choose to use the crossbars, they must be installed first. If not installing the Crossbars (#4) skip to STEP 5.

Peel the center rubber seal back on the Crossbar (#4) to expose the mounting holes. Drop a Socket Head Bolt (#8) into each hole.



2. Align the bolts from Step 1 to the Crossbar Mounting Bracket (#5). Loosely secure with the Locking Nuts (#10) using the provided Allen Key (#14) and Wrench (#13). Assure the Crossbar Mounting Bracket (#5) is straight with the Crossbar then fully tighten. Repeat on both ends for each Crossbar.



3. Place the Crossbars (#4) on the top of the GoTent (#1). If you're using the crossbars with any other storage systems, refer to that system for the distance required to install that system.



GoTent

4. Slide the M8 Square Nuts (#12) into the track on the side of the tent, 4 per side. Position the M8 Square Nuts (#12) behind the Crossbar Mounting Bracket (#5) and thread the Button Head Bolt (#11) into the square nut. Fully tighten all hardware to secure the crossbars to the tent top.



5. Position the GoTent on your vehicle. Take your time, make sure it is balanced and won't fall. Also, assure its position so the tent doesn't hit your vehicle in its open position.



6. Pull the plastic cap off the end of the aluminum track on the bottom of the GoTent. Place a M8 Hex Head Bolt (#9) into the Small Bolt Plate (#6), then slide the Small Bolt Plate (#6) into the track. Insert 4 per track. Reinstall the plastic cap to the end of the aluminum track. Repeat on the other track.



GoTent

7. Slide the bolts into position. A bolt must be on each side of your crossbar or luggage rack bar. This will require lifting the tent high enough to clear the bolt past the crossbar. Be careful to not push or lift enough to make the tent unstable with fear of it falling off the vehicle.



8. Place the Large Bolt Plate (#7) under your crossbar and into each bolt. There are two hole options on the large bolt plate to allow you the best fitment in your application. Use the M8 Locking Nuts (#10) to the bolts. DO NOT over tighten this hardware! Over tightening could bend the bolt plate or crush your crossbar. Secure all 4 mounting locations and fully tighten.

NOTE: The bolt is captured in the track but if the bolt gets pushed up it will spin. You may have to hold the bolt by the threads to keep it captured in the Small Bolt Plate (#6).



9. Use the Tent Key (#13) to lock/unlock the tent. Rotate and release the latch.



GoTent

10. Lift the GoTent lid and as it begins to pivot up you may need to lift at the bottom of the tent opening to allow air to enter the tent.

Next, move the elastic band down to the base of the tent.



11. Insert the Rain Fly Bow (#2) into the hole at the base of the tent. Bend the bow and insert it to the eyelet at the top of the rain fly. Do this for both bows to support the rain fly.

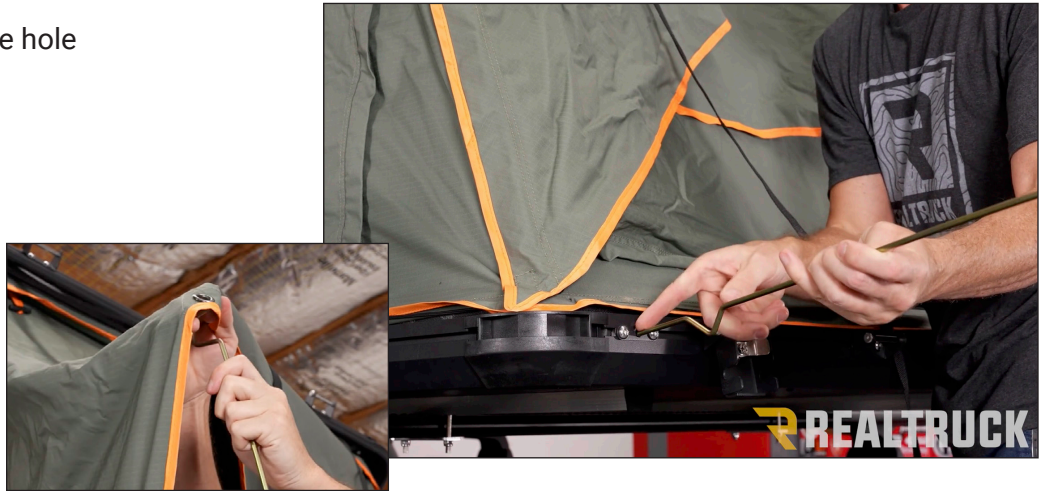

12. Lastly, open the Ladder(#3) and hook it to the tent.

NOTE: Make sure the ladder is on flat ground and secure before attempting to use it.

