

11540.46

Components and Hardware:

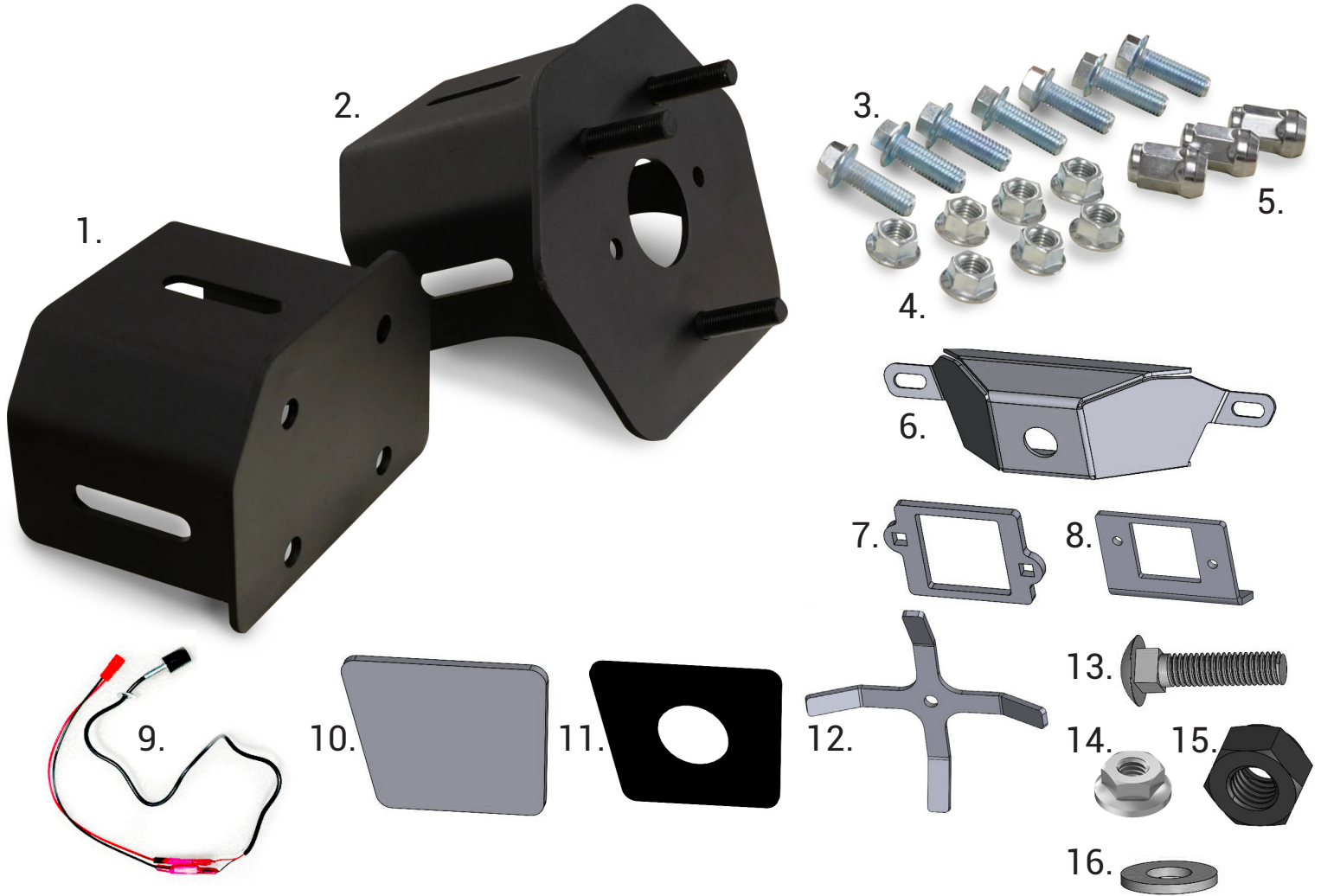

Components and Hardware:

1. Tire Mount, Swingout side.....	(1)	10. Tailgate Cover Plate	(1)
2. Tire Mount, Wheel side	(1)	11. Cover Plate Seal	(1)
3. M12 x 1.75mm 35mm, Flanged Bolt	(7)	12. Cover Plate Retainer	(1)
4. M12 x 1.75mm, Serrated Flange Nut	(7)	13. M4 x .70mm 16mm, Carriage Bolt.....	(3)
5. M14 x 1.50mm, Lug Nut.....	(3)	14. M4 x .70m, Serrated Flange Nut.....	(3)
6. Camera Relocation Mount.....	(1)	15. M6 x 1.00mm, Nylon-lock Nut.....	(1)
7. Camera Mount A	(1)	16. M6 Flat Washer	(1)
8. Camera Mount B	(1)		
9. Tag Light (LED Light, Washer, Nut, wire connectors, plug).....	(2)		

WingMate Tire Mount Kit, Jeep JT

STEP 1:

Determine the desired position for the tire mount by measuring the tire height and backspacing. Once the location is determined, proceed to install the Tire Mount, Swingout side (#1) onto the swingout.

Use the four M12 Flange Bolts (#3) and corresponding M12 Serrated Flange Nuts (#4) to secure the tire mount to the swingout. Ensure that the bolts are fully tightened to guarantee a secure fit.



STEP 2:

Place the second piece of the Tire Mount Wheel side (#2) over the Tire Mount Swingout side (#1). Utilize three M12 Flange Bolts (#3) and M12 Serrated Flange Nuts (#4) to securely attach these two together. It is crucial to position these correctly. Adjust the depth of the Tire Mount Wheel side (#2) to ensure the tire rests firmly on the face of the swingout. Consider applying a slight preload on the tire to enhance its security on the swingout.



STEP 3:

Elevate the spare tire and align it with the studs on the Tire Mount Wheel side (#2). Utilize the three M14 Lug Nuts (#5) provided to securely fasten the spare tire in place. It is recommended to have an assistant present when lifting the spare tire for added safety and ease of installation.



WingMate Tire Mount Kit, Jeep JT

STEP 4:

With the spare tire now mounted, the backup camera is obstructed. To restore its functionality, proceed to relocate the camera. Start by lowering the tailgate and removing the panel located in the center of the tailgate.



STEP 5:

Carefully unplug the camera, ensuring gentle handling to avoid damaging the plug. Release the camera from the plastic retainer by squeezing the tabs and gently pulling it to the side.

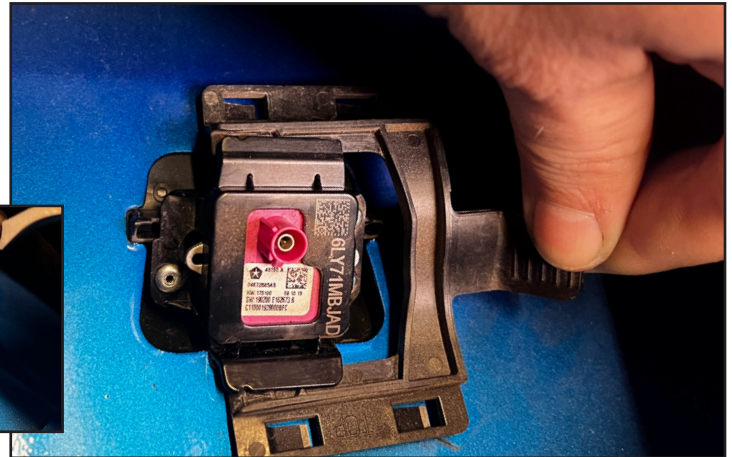
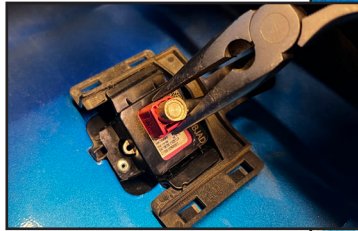

STEP 6:

Separate the camera wire from the tailgate harness by removing any cloth electrical tape and plastic retainers as necessary. Once the camera wire is separated, guide it out through the bottom of the tailgate. Open the plastic access panel on the back edge of the bed and pull the camera wire through so that it is now positioned under the bed of the truck.

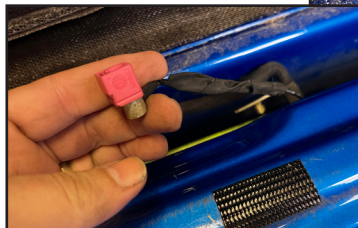

WingMate Tire Mount Kit, Jeep JT

STEP 7:

With the camera has been removed, proceed to install the Tailgate Cover Plate (#10) to cover the void. Attach the Cover Plate Seal (#11) cover plate for added insulation. Position the cover plate on the front of the camera hole and secure it using the Cover Plate Retainer (#12) inside the tailgate. Tighten the retainer in place with a M6 Flat Washer (#16) and an M6 Nylon-lock Nut (#15).



STEP 8:

To remove the camera from the OE mount, use small Torx drive to remove. Exercise caution to avoid scratching the lens of the camera during the removal process.

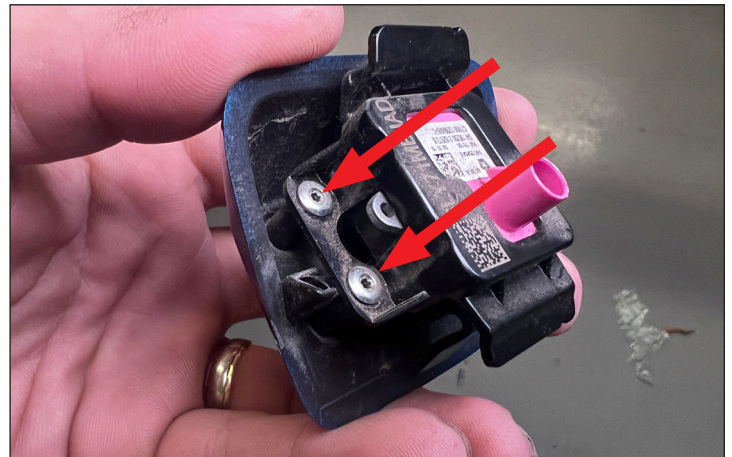

STEP 9:

With the camera removed install it onto Camera Mount B (#8). Ensure that it drops into the mount with the plug oriented towards the bottom. Following this, position Camera Mount A (#7) over the back to sandwich the camera onto the mount. Utilize the M4 Carriage Bolt (#13) and M4 Serrated Flange Nuts (#14) for this assembly. Be cautious not to over-tighten to prevent any damage to the camera.



WingMate Tire Mount Kit, Jeep JT

STEP 10:

Install the camera into the Camera Relocation Mount (#6) by using the M4 Carriage Bolt (#13) through the bottom of the mount and securing it with the M4 Serrated Flange Nuts (#14). Slide it into position, ensuring that only the lens protrudes from the mount, and then fully tighten the bolt to secure the camera in place.

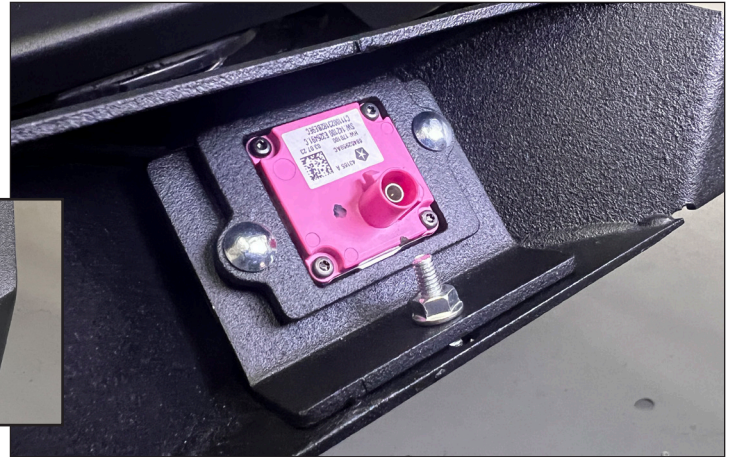

STEP 11:

Feed the camera wire under the bed to the top of the bumper. Connect the camera and position the license plate in place. Thread the Tag Light (#9) wire and stud through the camera mount, the license plate, and then the bumper. Secure it behind the bumper using the included a flat washer and nut. Wire the tag light to the existing tag light harness. Secure any loose wires with zip ties and tape for a tidy installation. This completes the installation process

