

➤ Instructions

Thule Yepp 2 Mini
120211XX



- EN** Front Child Bike Seat
FR Siège vélo enfant avant
ES Asiento para niños en la parte delantera de la bicicleta
DE Vorne montierter Fahrradkindersitz
NL Fietszitje voor voorop
PT Cadeirainha infantil dianteira para bicicleta
IT Seggiolino anteriore per bambini
SV Frontmonterad cykelbarnstol
DK Foranmonteret cykelstol
NO Frontmontert barnesete til sykkel
FI Eteen kiinnitettävä polkupyörän lastenistuin
IS Barnasæti framan á reiðhjól
ET Eesmine jalgratta lasteiste
LV Velosipēda priekšējais bērna sēdekļis
LT Priekinė vaikiška dviračio kėdutė
RU Переднее детское велосипедное сиденье
UK Передне дитяче велосипедне крісло
PL Przedni rowerowy fotelik dziecięcy
- CS** Přední dětská cyklosedačka
HU Kerékpáros első gyerekülés
RO Scaun față de copii pentru bicicletă
SK Predná detská cyklosedačka
SL Sprednji otroški kolesarski sedež
BG Предна детска седалка за велосипед
HR Dječja sjedalica za bicikl koja se postavlja sprijeda
EL Μπροστινό παιδικό κάθισμα ποδηλάτου
TR Öne Bağlanan Çocuk Bisiklet Koltuğu
MT Sedil tar-Rota għat-Tfal li Jitpoġġa Quddiem
- HE** מושב אופניים קדמי לילד
AR مقعد الدراجة الأمامي للطفل
- ZH (CN)** 前置式儿童自行车座椅
ZH (TW) 前置式自行車兒童座椅
JA サイクル前部用チャイルドシート
KO 전면 어린이 자전거 시트
TH เก้าอี้เด็กสำหรับติดตั้งหน้าจักรยาน
MS Tempat Duduk Basikal Kanak-kanak Depan

EN 14344:2022

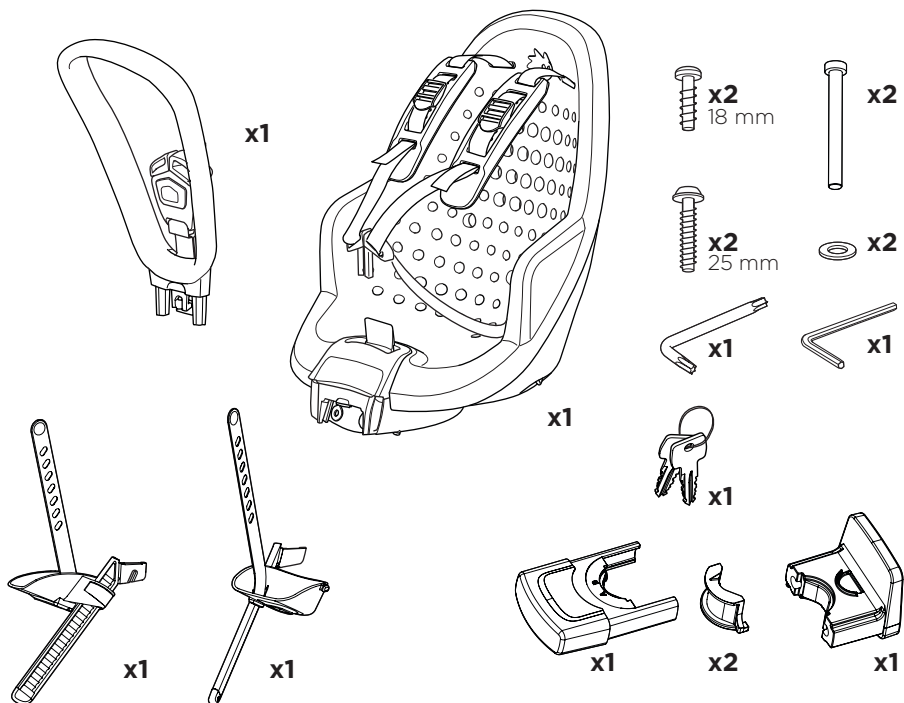

- EN** Please read the following instructions carefully and keep them for future reference.
- DE** Bitte die folgenden Anleitung aufmerksam durch und bewahren Sie sie zum späteren Nachschlagen auf.
- FR** Veuillez lire attentivement les instructions suivantes et les conserver pour référence future.
- NL** Dient u zorgvuldig de volgende instructies te lezen en deze als toekomstig naslagwerk te bewaren.
- IT** Leggi le seguenti istruzioni attentamente e conservale per consultazioni future.
- ES** Lea las instrucciones siguientes atentamente y guárdelas para consultas posteriores.
- PT** Leia cuidadosamente as instruções a seguir e guarde-as para referência futura.
- SV** Vi ber dig läsa följande instruktioner noggrant och därefter behålla dem för framtida bruk.
- DK** Skål du læse følgende anvisninger grundigt igennem og gemme dem til fremtidig reference.
- NO** Bør du lese disse instruksjonene nøye. Ta vare på dem i tilfelle du får bruk for dem senere.
- FI** Lue seuraavat ohjeet huolellisesti. Pidä ohjeet tallessa.
- IS** Lestu þessar leiðbeiningar vandlega áður en þú og geymdu þær til síðari nota.
- ET** kasutuselevõttu lugege järgmised juhised hoolikalt läbi ja hoidke need alles.
- LV** lūdzu, izlasiet uzmanīgi tālāk sniegtos norādījumus un saglabājiet tos turpmākai izmantošanai.
- LT** atidžiai perskaitykite toliau pateiktas instrukcijas ir jų neišmeskite, kad galėtumėte peržiūrėti ateityje.
- PL** należy dokładnie przeczytać następujące instrukcje i zachować je do wykorzystania w przyszłości.
- RU** внимательно изучите представленные ниже инструкции и сохраните их для дальнейшего использования.
- UK** ознайомтеся з нижченаведеними інструкціями й зберігайте їх для довідки в майбутньому.
- BG** прочетете внимателно следните инструкции и ги запазете за бъдещи справки.
- CS** si pečlivě přečtete následující pokyny a uložte si je, abyste se k nim mohli kdykoli vrátit.
- SK** si pozorne prečítajte nasledujúce pokyny a uložte si ich, aby ste sa k nim mohli kedykoľvek vrátiť.
- SL** skrbno preberite navodila v nadaljevanju in jih shranite.
- HR** pažljivo pročitajte sljedeće upute i sačuvajte ih za buduću uporabu.
- RO** citiți cu atenție următoarele instrucțiuni și păstrați-le pentru consultare ulterioară.
- HU** használatbavétele előtt figyelmesen olvassa el az alábbi tudnivalókat, és tartsa azokat később is hozzáférhető helyen
- EL** διαβάστε προσεκτικά τις παρακάτω οδηγίες και φυλάξτε τις για μελλοντική αναφορά.
- TR** kullanmadan önce aşağıdaki talimatları dikkatle okuyun ve gelecekte başvurmak amacıyla saklayın.
- MT** jekk jogħġbok aqra l-istruzzjonijiet li ġejjin bir-reqqa u zommhom għal referenza futura.

HE קרא את ההוראות להלן בקפידה ושומר עליהן לעיון במועד מאוחר יותר.
AR يرجى قراءة التعليمات التالية بعناية والاحتفاظ بها للرجوع إليها في المستقبل.

ZH (CN) 请仔细阅读以下说明，并保留该说明以供日后参考。

ZH (TW) 請詳閱以下說明，並妥善保管以便未來參考使用。

JA をご利用になる前に、以下の手順を最後までお読みいただき、今後も参照できるように保管してください。

KO 을 사용하기 전에 다음 지침을 잘 읽고 나중에 참고할 수 있도록 보관해 주십시오.

TH โปรดอ่านคำแนะนำต่อไปนี้อย่างละเอียดและเก็บไว้เพื่อใช้อ้างอิงในอนาคต

MS sila baca arahan berikut dengan teliti dan simpan arahan ini untuk rujukan masa hadapan.

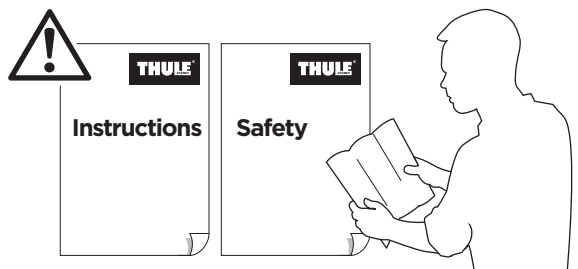





9-36 M
9-15 kg 20-33 lbs
93 cm 36.61 inch



Your Key-Number

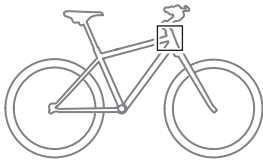

0-9 M



Min:
21 mm
0.83 inch

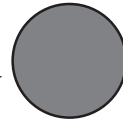
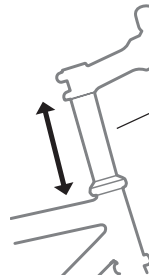

Ø 22-28 mm
Ø 0.87-1.10 inch

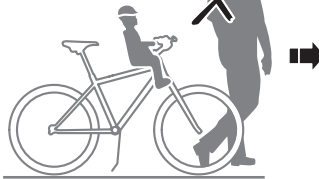

Max. 25 km/h
15 mph

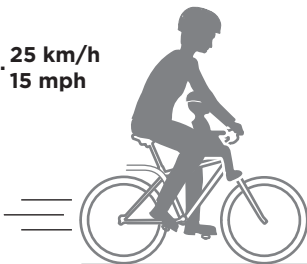

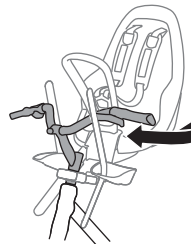
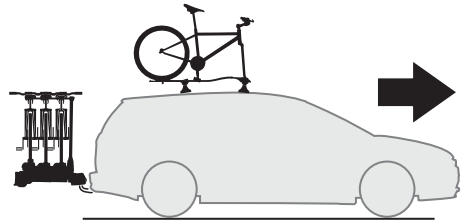
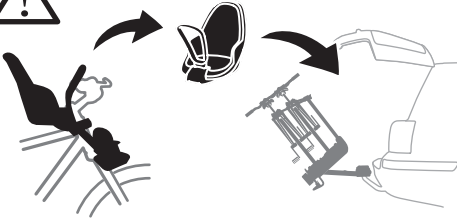
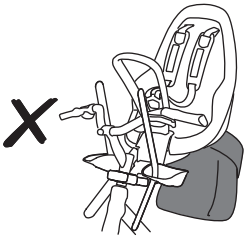



1

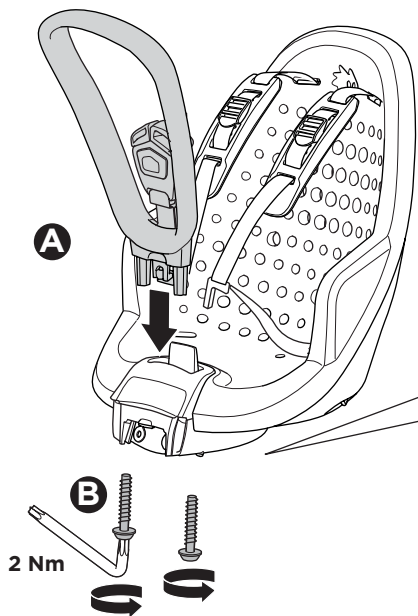

B

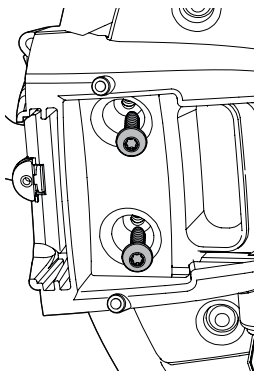

2

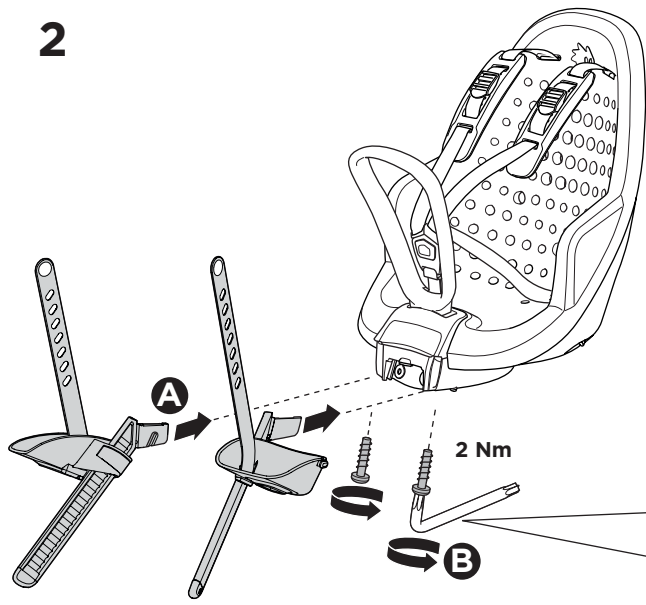

B

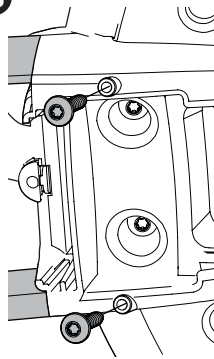

3

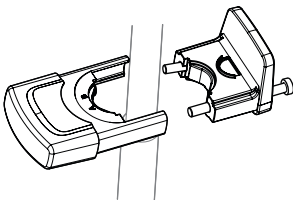
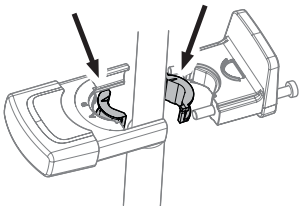
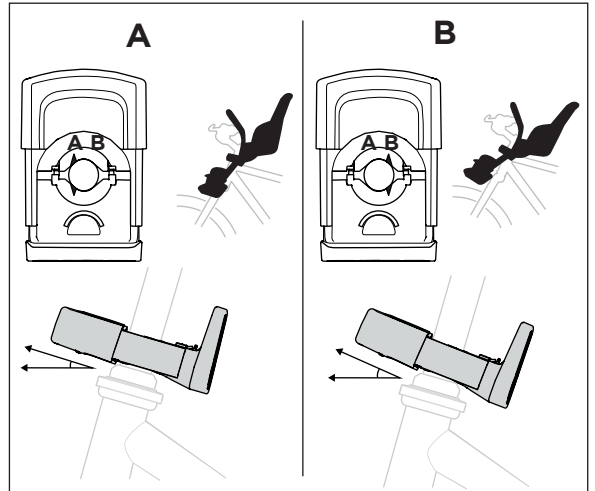
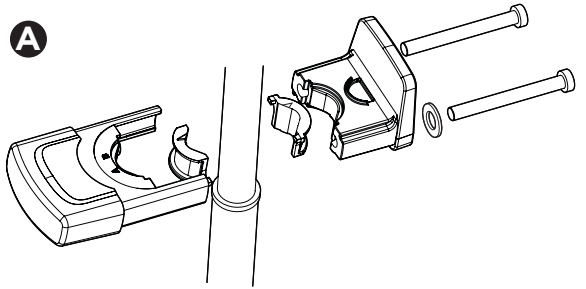
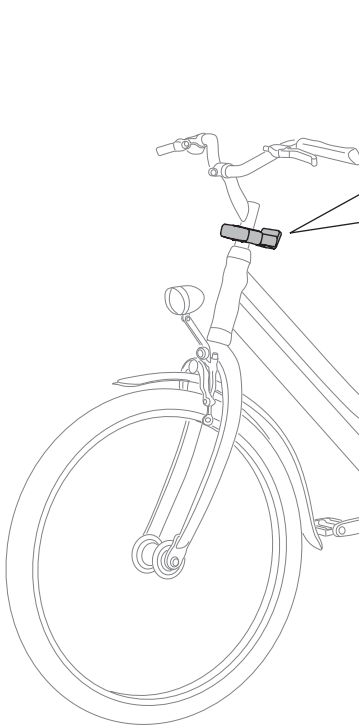
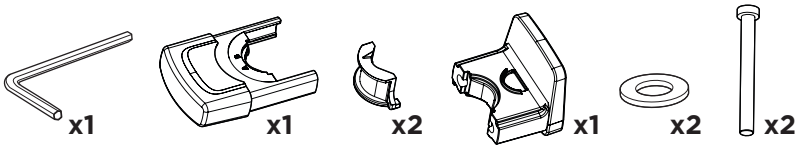

B

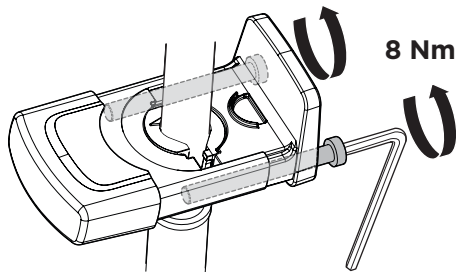

4

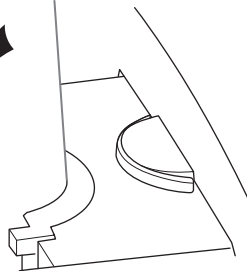
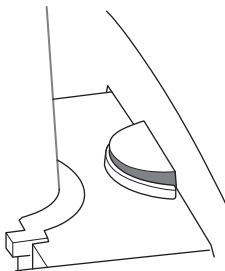
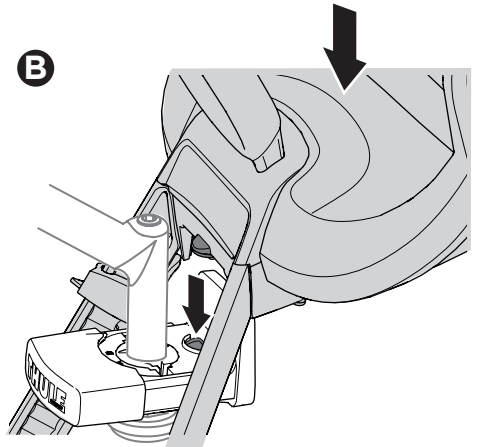
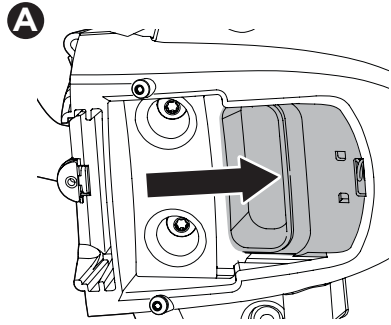
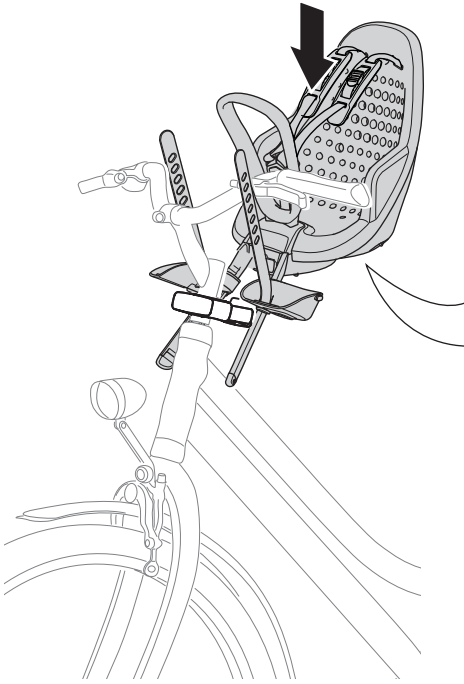

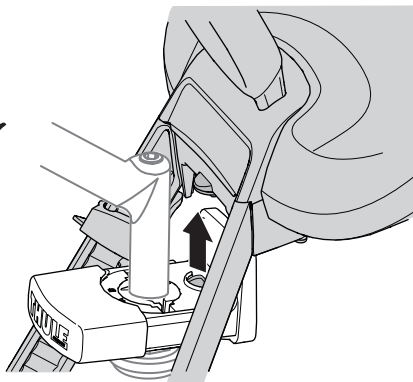
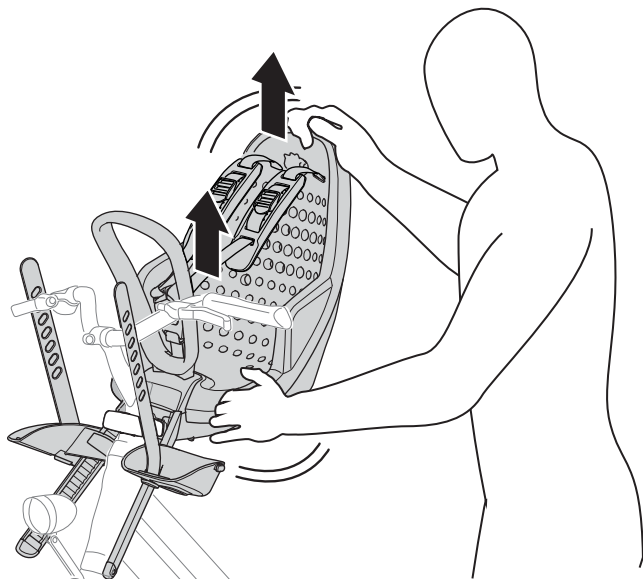

4

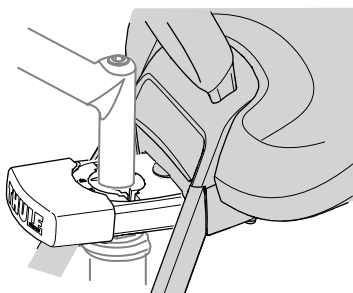

5



5

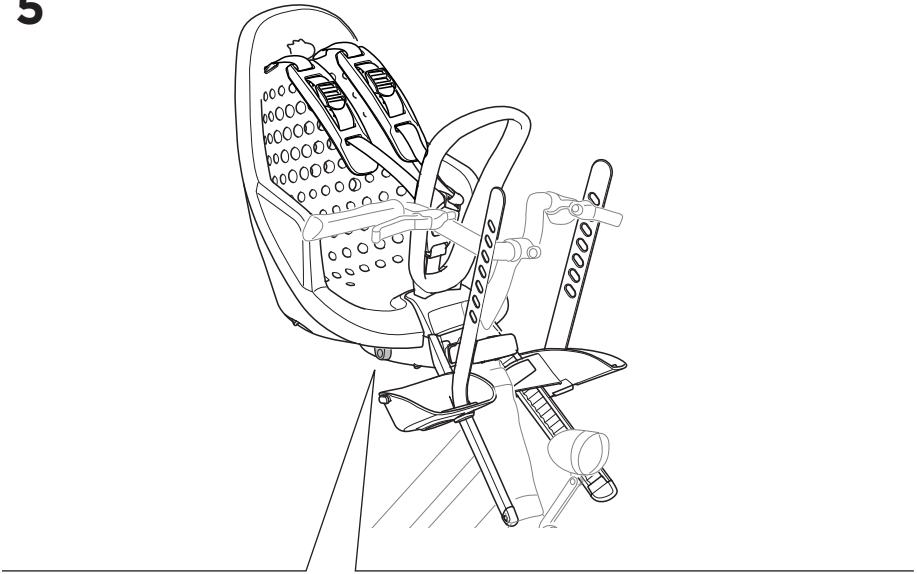

A

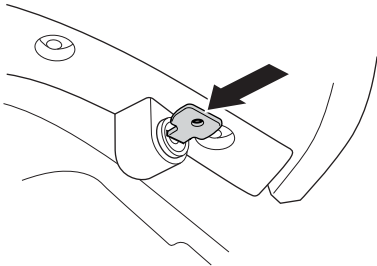

B

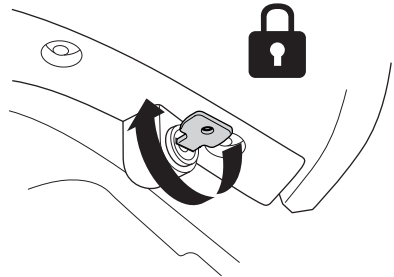

i

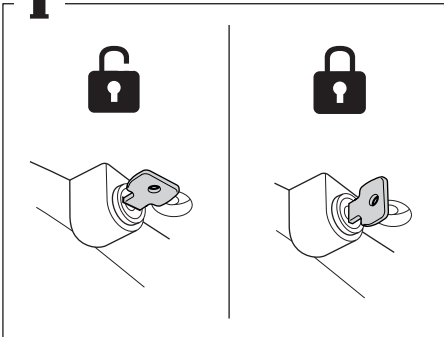

C

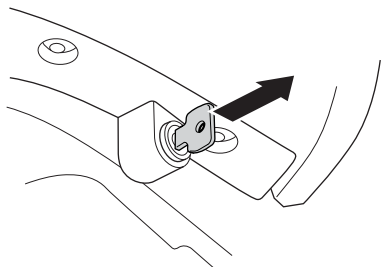



1

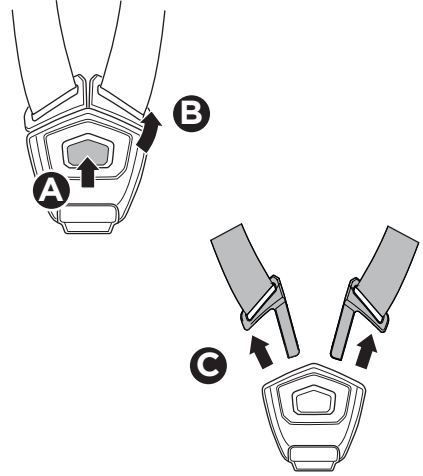
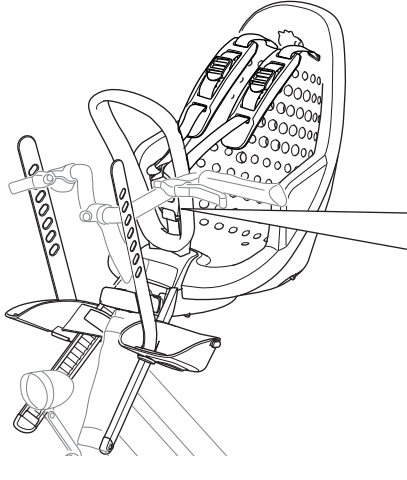

2

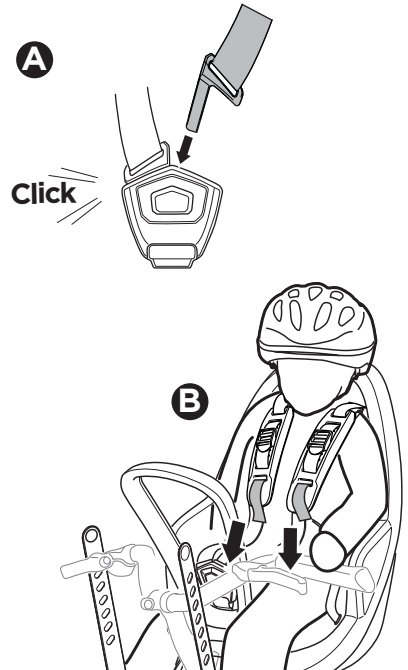
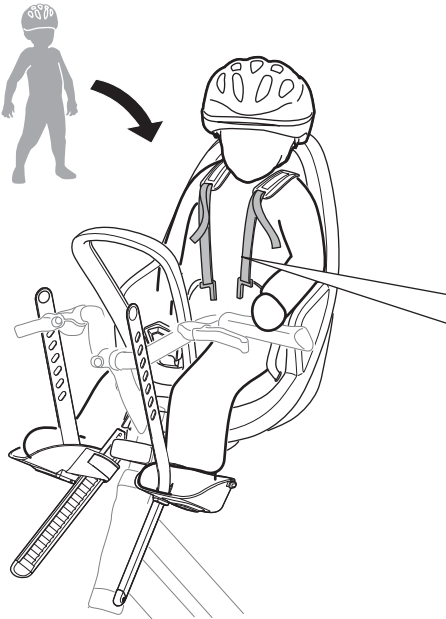

3

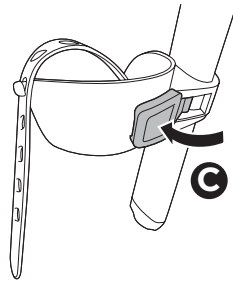
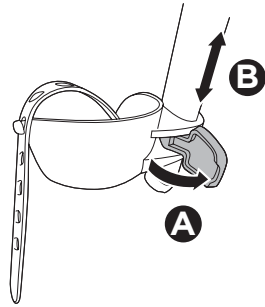
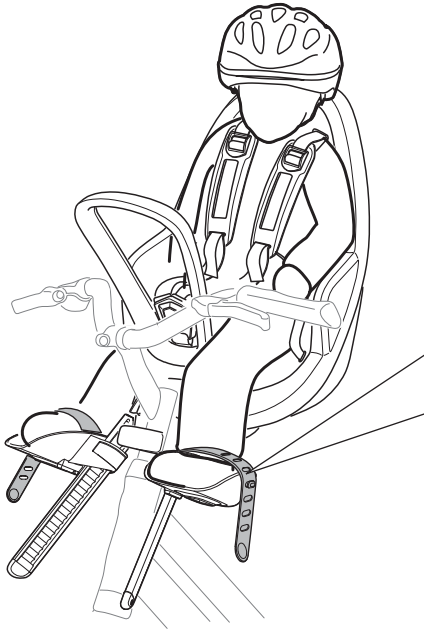

D

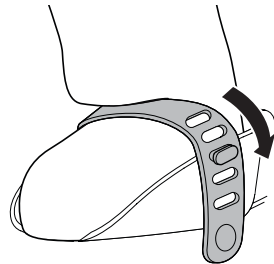

i

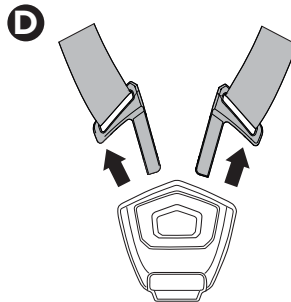
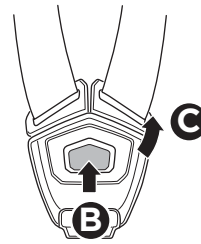
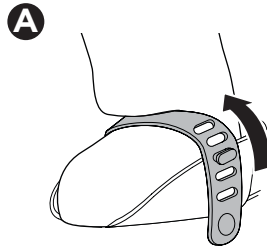
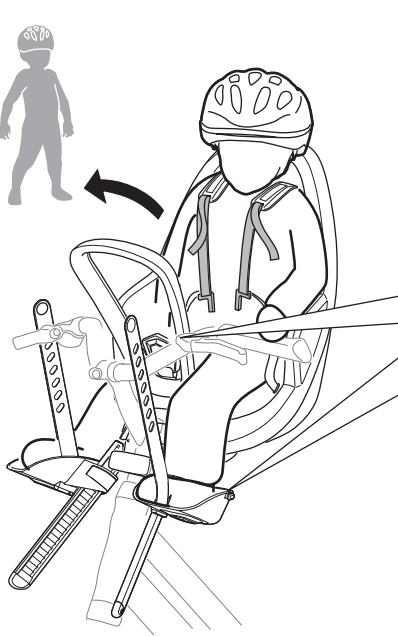

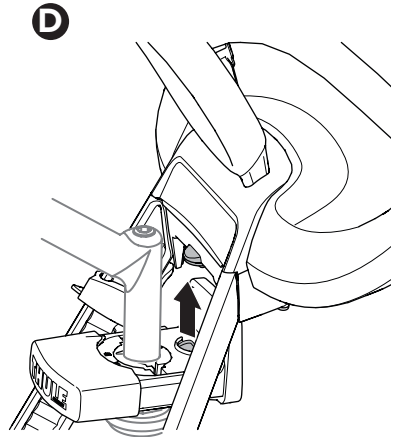
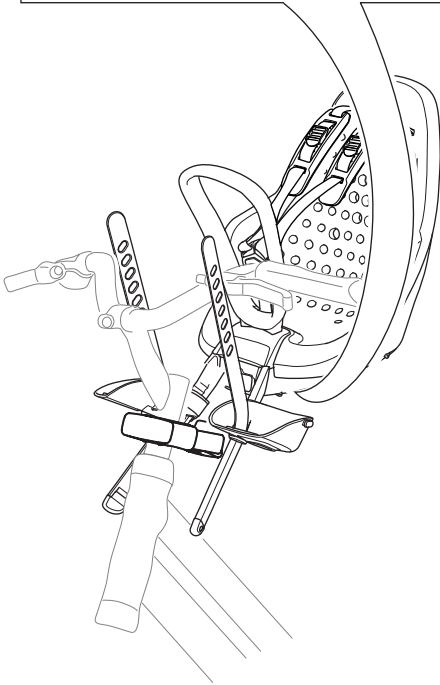
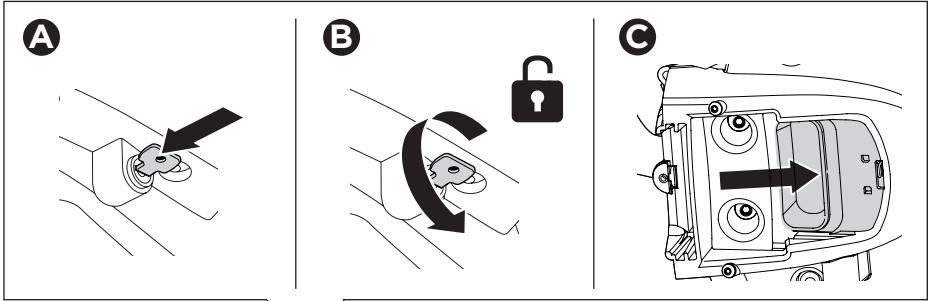
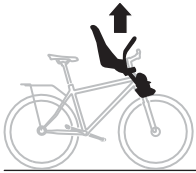

EN Accessories
FR Accessoires
ES Accesorios
DE Zubehör
NL Accessoires
PT Acessórios
IT Accessori
SV Tillbehör
DK Tilbehør
NO Tilbehør
FI Lisävarusteet
IS Aukabúnaður

ET Tarvikud
LV Piederumi
LT Priedai
RU Аксессуары
UK Аксесуари
PL Akcesoria
CS Příslušenství
HU Kiegészítők
RO Accesorii
SK Príslušenstvo
SL Dodatna oprema
BG Аксесоари

HR Dodatna oprema
EL Αξεσουάρ
TR Aksesuarlar
MT Aċċessorji

אביזרים **HE**
الملحقات **AR**

ZH (CN) 附件
ZH (TW) 配件
JA アクセサリー
KO 액세서리
TH อุปกรณ์เสริม
MS Aksesori

Thule Yepp Raincover

12020971



Thule Yepp Mini SlimFit Adapter

12080402



Thule Yepp Mini Windscreen

12020906

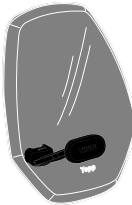

Thule Yepp Mini Handlebar Padding

12020901



Thule Yepp Mini Handlebar Padding Miffy

12020902

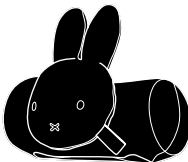

 Thule Sweden AB, Borggatan 5
335 73 Hillerstorp, SWEDEN

› PART OF THULE GROUP

 info@thule.com

© Thule Group 2022 All rights reserved.

 www.thule.com

5560136001

