

INSTALLATION MANUAL

13498

Level of Difficulty

Easy

Installation difficulty levels are based on time and effort involved and may vary depending on the installer level of expertise, condition of the vehicle and proper tools and equipment.

Weight Carrying Capacity

Gross trailer weight (GTW)	2,000 lbs.
Tongue weight (TW)	200 lbs.

Parts List

Item	Qty	Description
1	4	Hex bolt, M12
2	4	Conical-toothed washer, 1/2"

Tools Required

Ratchet	Socket, 19mm
Socket, 12mm	Torque wrench
Socket, 17mm	--

* For a tools reference guide visit curtmfg.com/trailer-hitch-installation

⚠ WARNING

Never exceed the vehicle manufacturer's recommended towing capacity.

Product Photo



NOTICE

Visit www.curtmfg.com for a full-color copy of this instruction manual, as well as helpful videos, guides and much more!

Before you begin installation, read all instructions thoroughly.

Proper tools will improve the quality of installation and reduce the time required.

This installation requires:

- May require lowering of exhaust
- Removal of recovery loop

Periodic inspection of the trailer hitch should be performed to ensure all mounting hardware remains tight and structural components are secure.

To help prevent damage to the product or vehicle, refer to the specified torque specifications when securing hardware during the installation process.

SAFETY INSTRUCTIONS

Safety glasses should be worn at all times while installing this product.

Product Registration and Warranty

CURT stands behind our products with industry-leading warranties. To get copies of the product warranties, register your purchase or provide feedback, visit: warranty.curtgroup.com/surveys

ASSEMBLY

Parts List

Item	Qty	Description
1	4	Hex bolt, M12
2	4	Conical-toothed washer, 1/2"

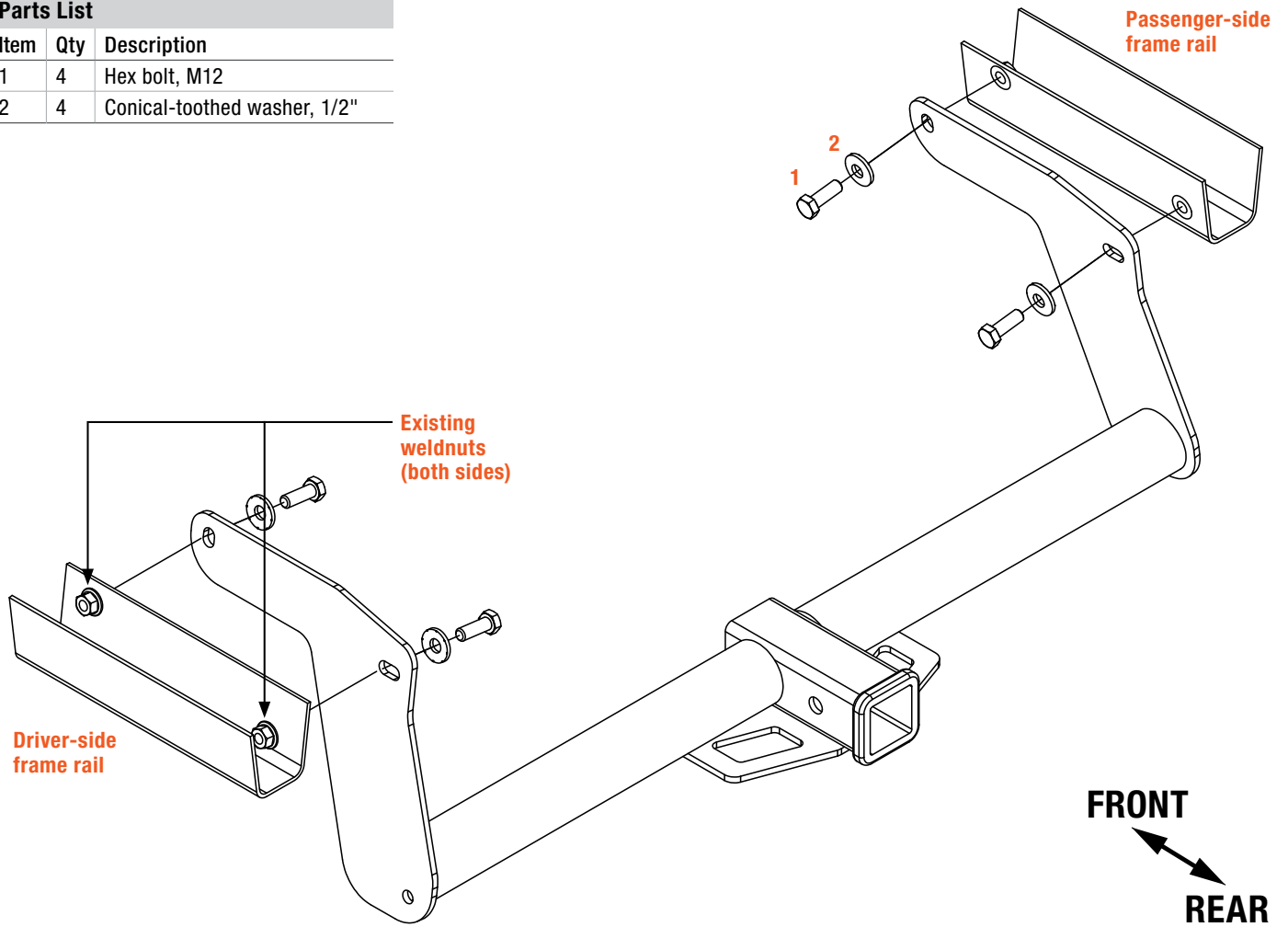

CONICAL TOOTHED WASHER ORIENTATION

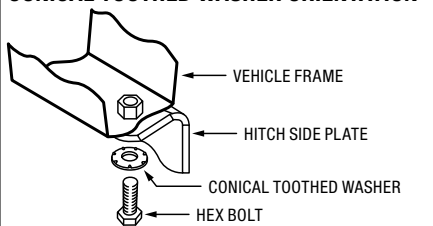

Step 1

Using a 12mm socket, remove the two bolts securing the muffler hanger bracket from the frame on both sides of vehicle. Unhook the exhaust hanger isolator in front of the muffler as well.

NOTICE

Make sure to support the exhaust to prevent damaging it.



Step 2

Use a 17mm socket to remove the two bolts securing the recovery loop to the frame.

Return the recovery loop and fasteners to the vehicle owner.



Step 3

Remove the decals / plugs over the weldnuts on the inner side of the frame rails. Raise hitch into position between the frame rails and loosely install the supplied M12 bolts (#1) and conical-toothed washers (#2) with a 19mm socket.

Step 4

Torque all M12 fasteners to 86 ft-lbs.

Step 5

Reinstall the exhaust hanger brackets and isolator removed in step 1.

Final Installed Image



TOWING BASICS & SAFETY INFORMATION

For information on safely towing your trailer, visit curtmfg.com/understanding-towing.