

Silverado/Sierra-2019 POWER BOARD

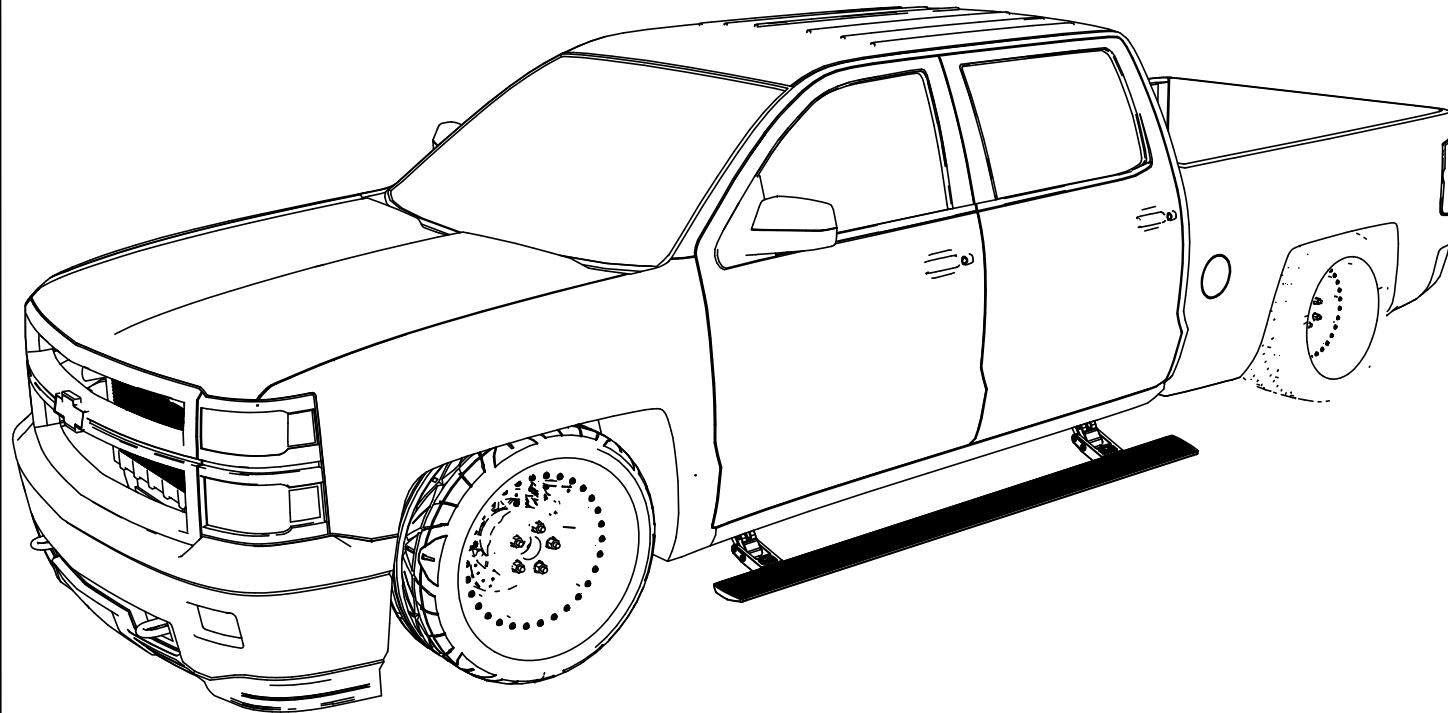

Silverado/Sierra-2019 POWER BOARD

INSTALLATION GUIDE

INSTALLATION TIME

00:00

APPLICATION : Silverado/Sierra 1500/2500/3500 EXT/Double Cab 2019
Silverado/Sierra 1500/2500/3500HD Crew Cab 2019

PRODUCT NUMBER : PST05-4310
PST05-4410

TOOLS REQUIRED :

- ① 5mm Hex Key Wrench (Allen Wrench)
- ② 12mm Socket Spanner
- ③ 12mm Ratchet Wrench
- ④ Pry Tool
- ⑤ Wire Cutter/ Stripper
- ⑥ Vinyl Tape
- ⑦ Screw Driver

Contents

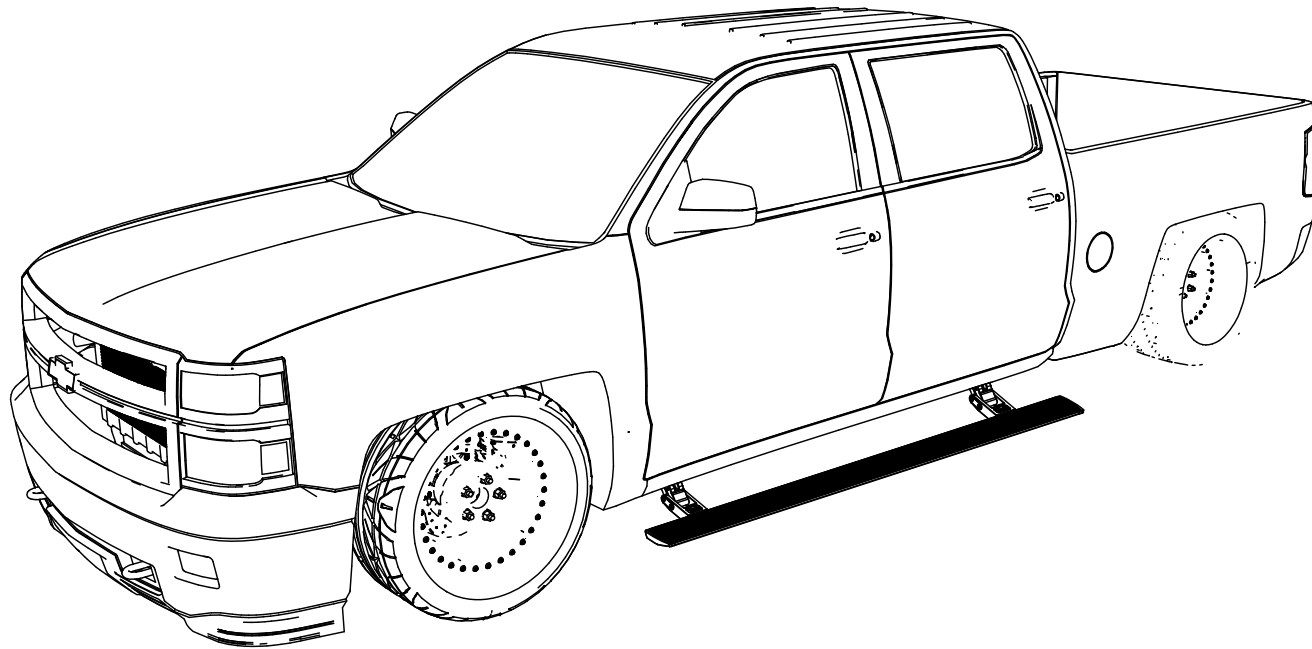

Product Technical Specification.....	02
Product Packing List.....	03
Mechanical Installation.....	06
Electrical Installation.....	11
Maintenance.....	21
Warranty Card.....	23

The product is developed and produced by T-MAX, and the related patents are blow.
Patents:US8,469,380;US9,656,609;US9,308,870;US9,688,205;US9,669,766

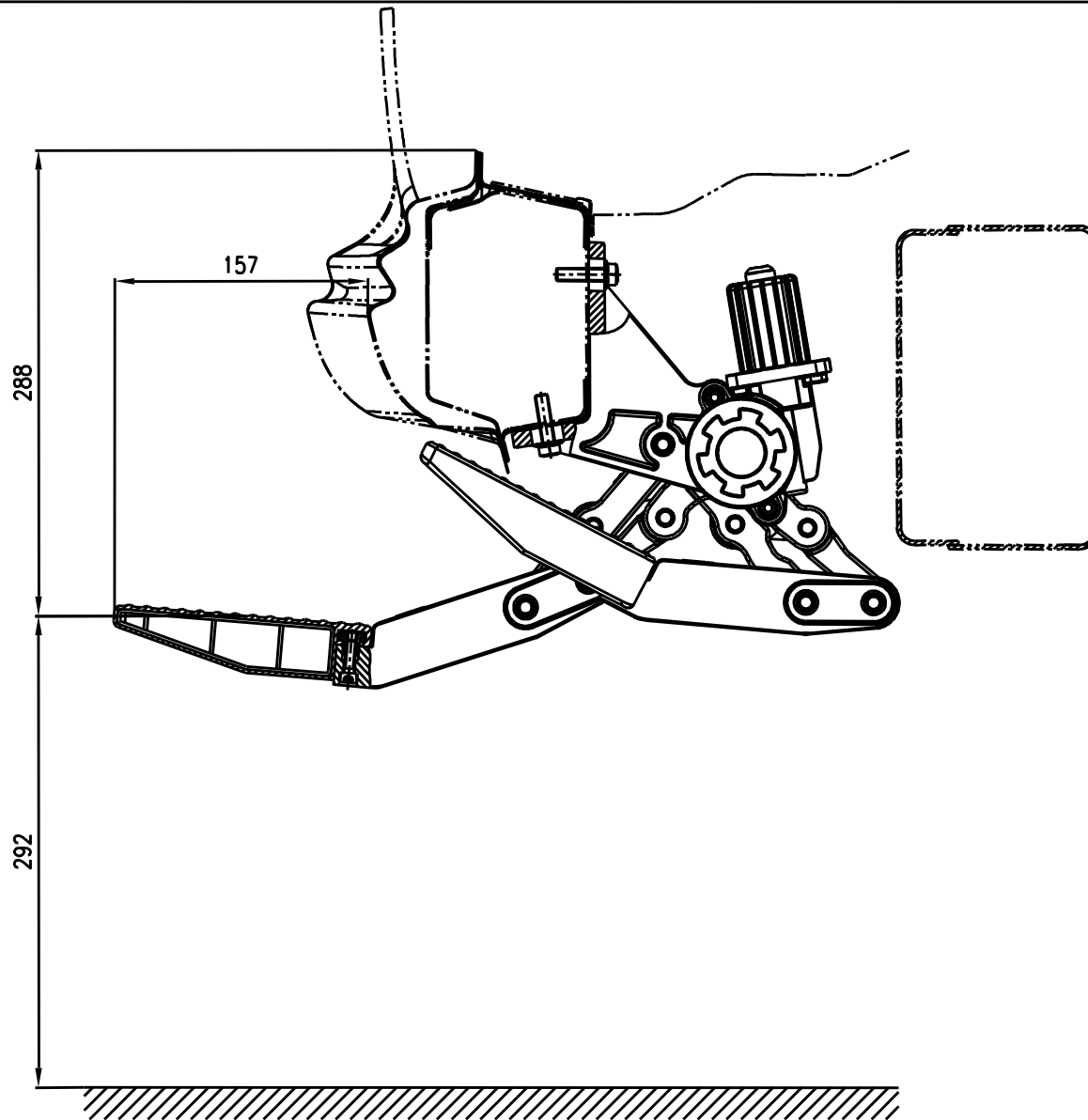

Product Technical Specification

Rated Voltage: 12V

Specified Load: $\leq 350\text{kg}$

Gross Weight: PST05-4310 34.8kg

PST05-4410 36kg

Forward extension size: 157mm

(Horizontal distance between the edge of power board and the vehicle door when the board extends)

Board falling dimension: 288mm

(Vertical height difference between the edge of power board and the vehicle door while board extending.)

(Both dimensions of forward and falling are theoretical, which may vary due to uncertainties such as installation error, manufacturing errors of vehicle bottom and etc.)

Note: Impact load is not allowed.

Please make sure the children and the aged will keep 20cm safe distance while power board is working to avoid any bump or jam.

Product Packing List

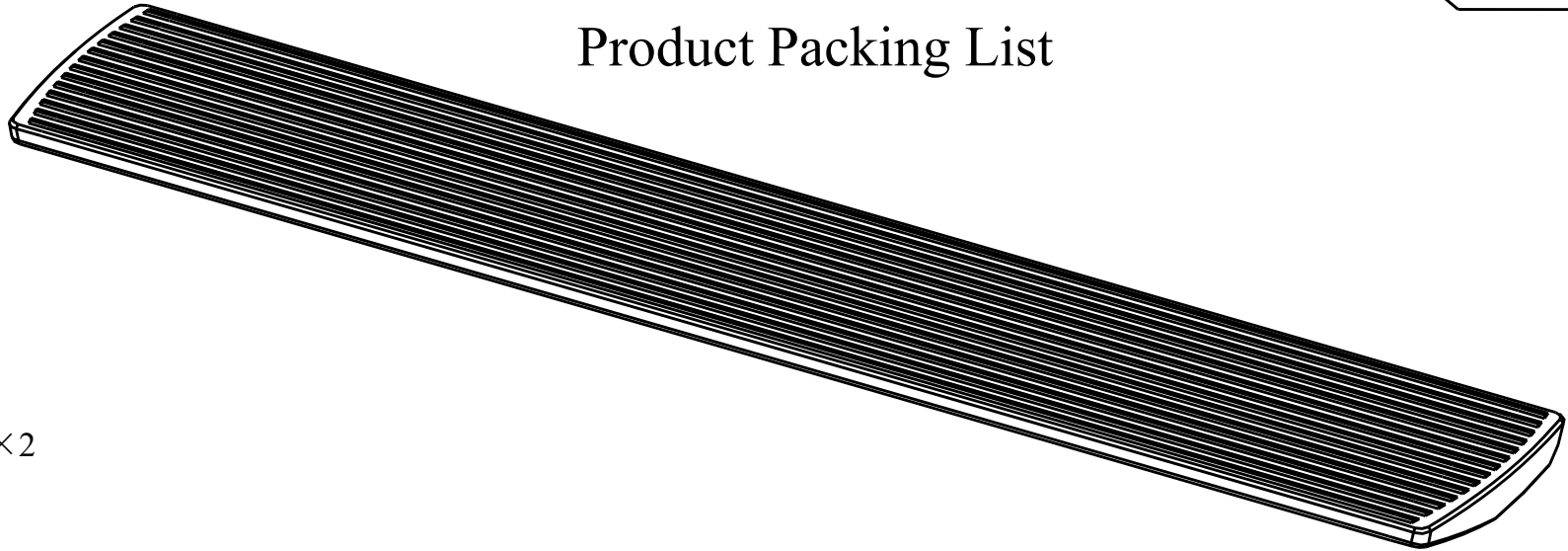

① - Board Assembly × 2

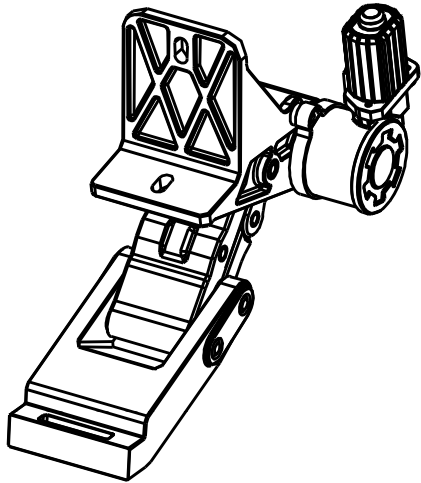

② - Front Motor Linkage Left × 1
Rear Motor Linkage Left × 1
6114100.1L

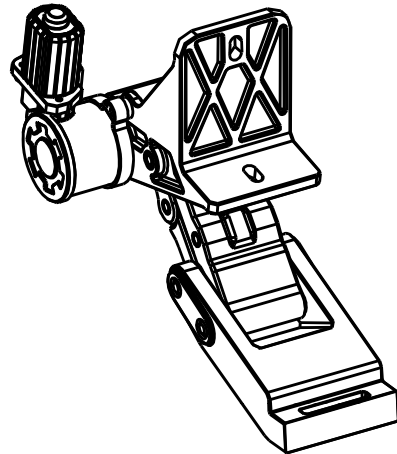

③ - Front Motor Linkage Right × 1
Rear Motor Linkage Right × 1
6114100.1R

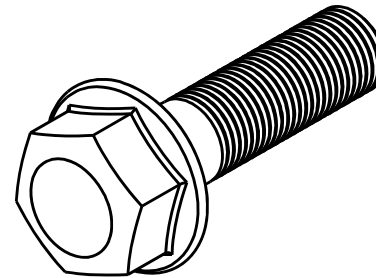

④ - Hexagon Flange Bolt × 8
QC/T340-1999 M8 × 30

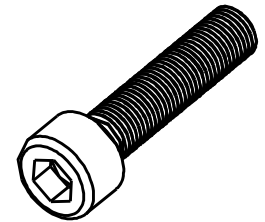

⑤ - Socket Cap Screw × 8
GB/T70.1-2000 M6 × 25

Silverado/Sierra-2019

E-BOARD

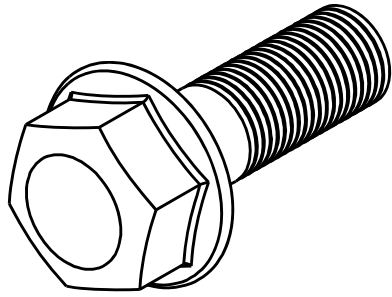

⑥ - Hexagon Flange Bolt × 2
QC/T340-1999 M8×25

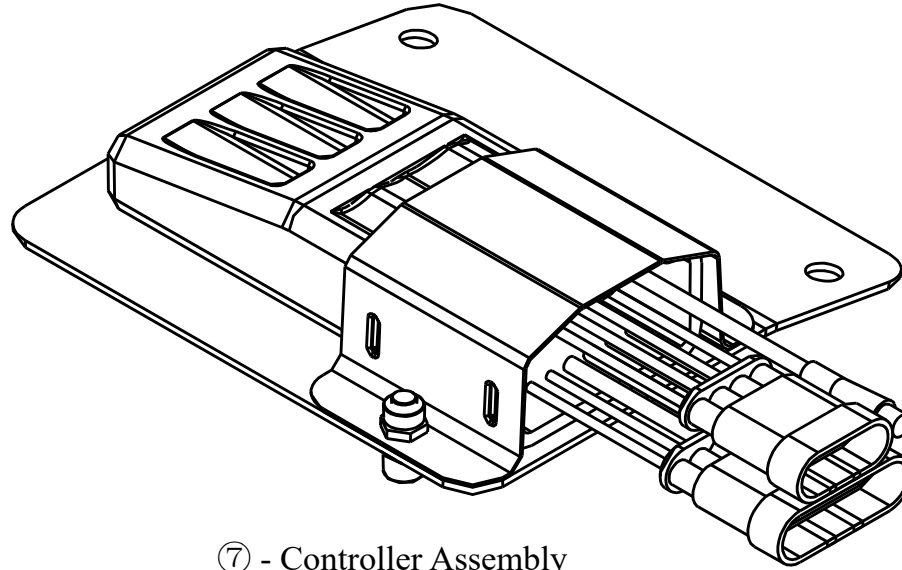

⑦ - Controller Assembly
6114100.4.4ZJ

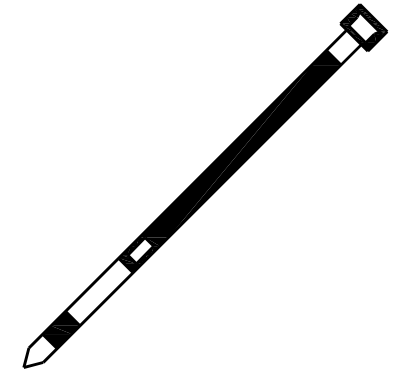

⑧ - Wire Tie × 25
GB/T22344-2008 5×300

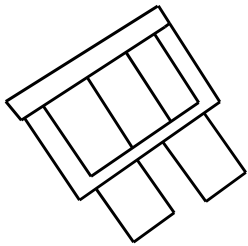

⑨ - Fuse × 2



Magnet

⑩ - Wired Magnetic Induction
Module × 2
- Magnet × 4

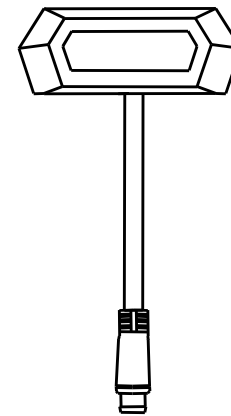

⑪ - LED Lamp × 4
6161100.4.8
(Optional)

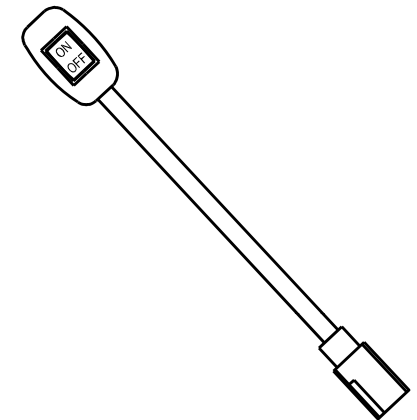

⑫ - Power Board Switch × 1
6124151.4.9

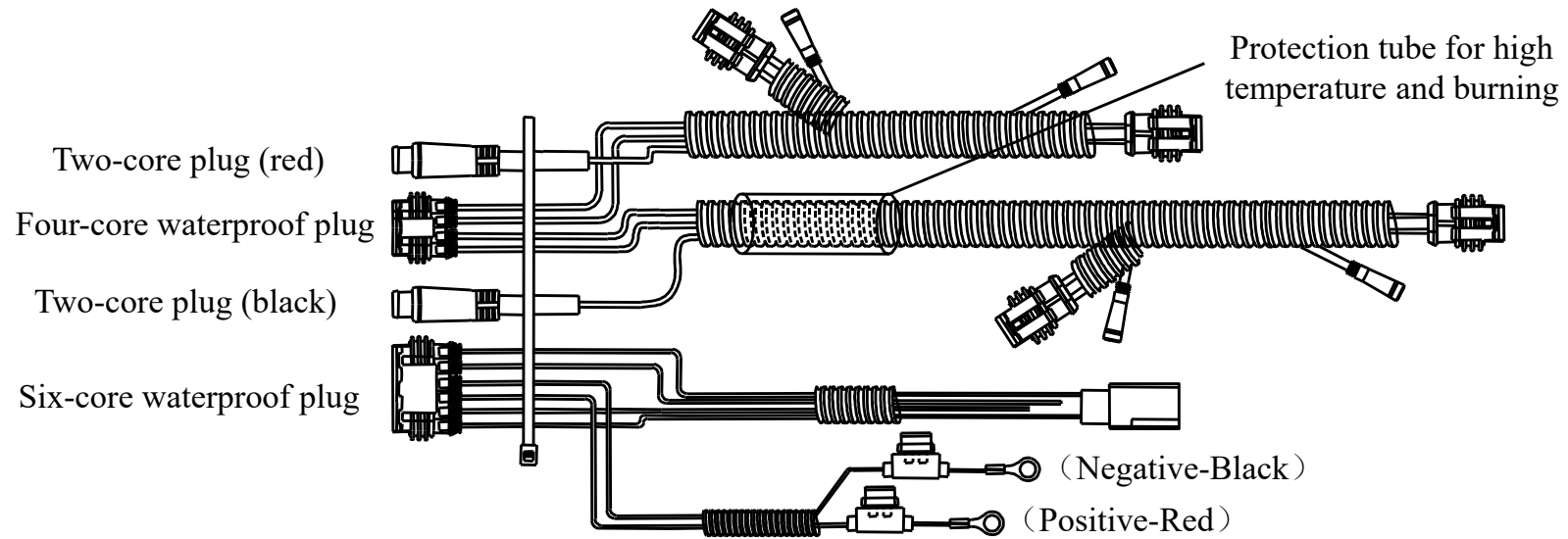

⑬ - Control Input Wire ×1 6120100.4.1

Mechanical Installation

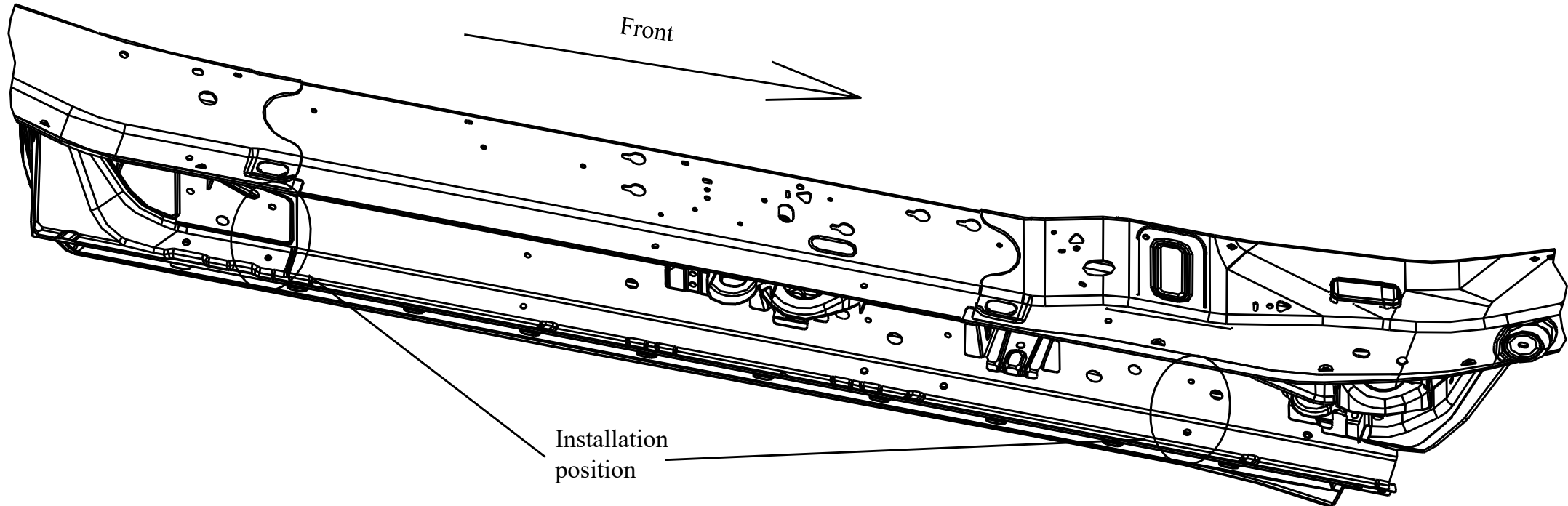

Installation Position On the Left Side

As shown in the picture, these are the two installation positions on the left side of the vehicle, and the installation mode of the front and rear linkage are same .

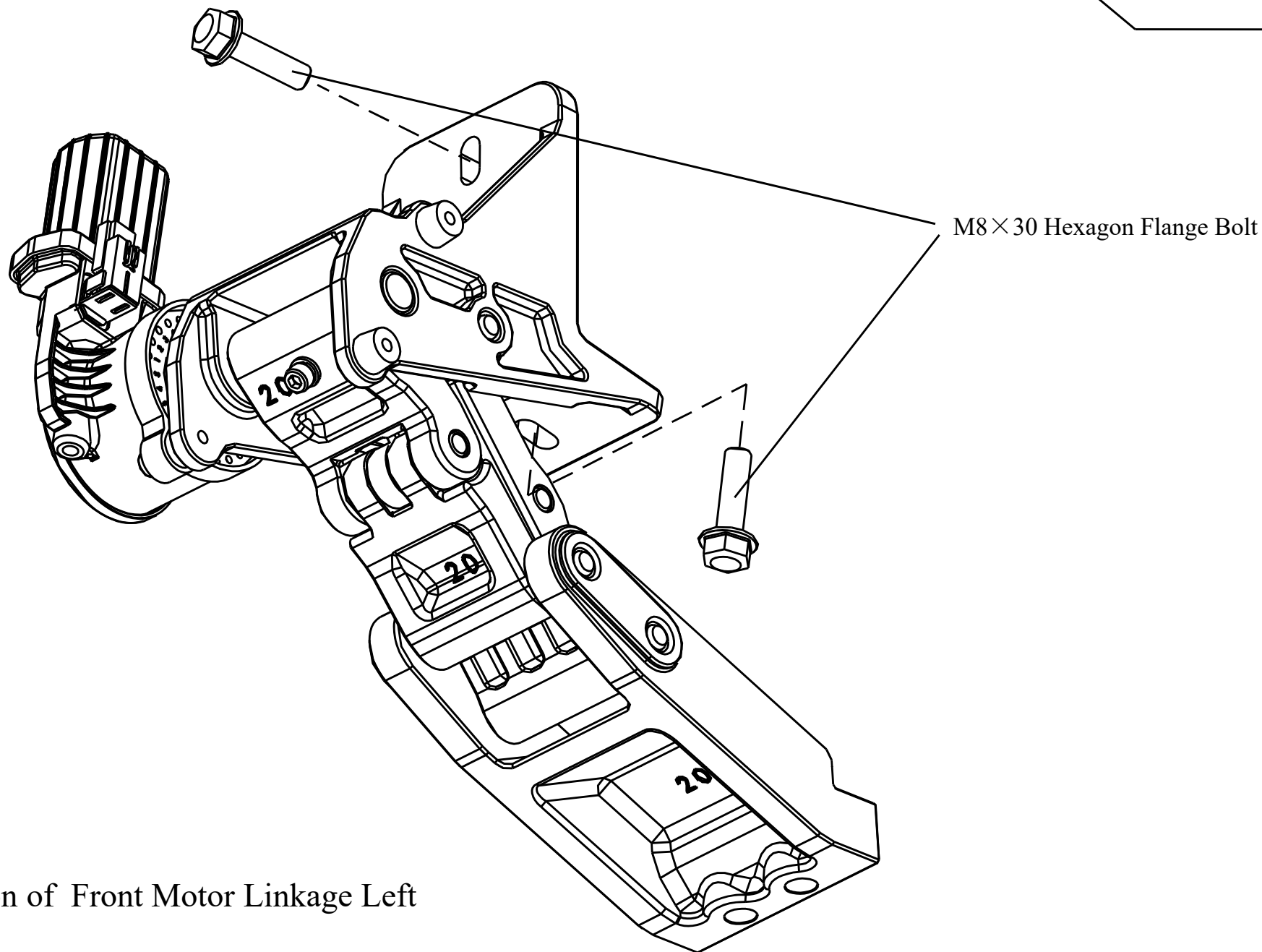

Installation of Front Motor Linkage Left

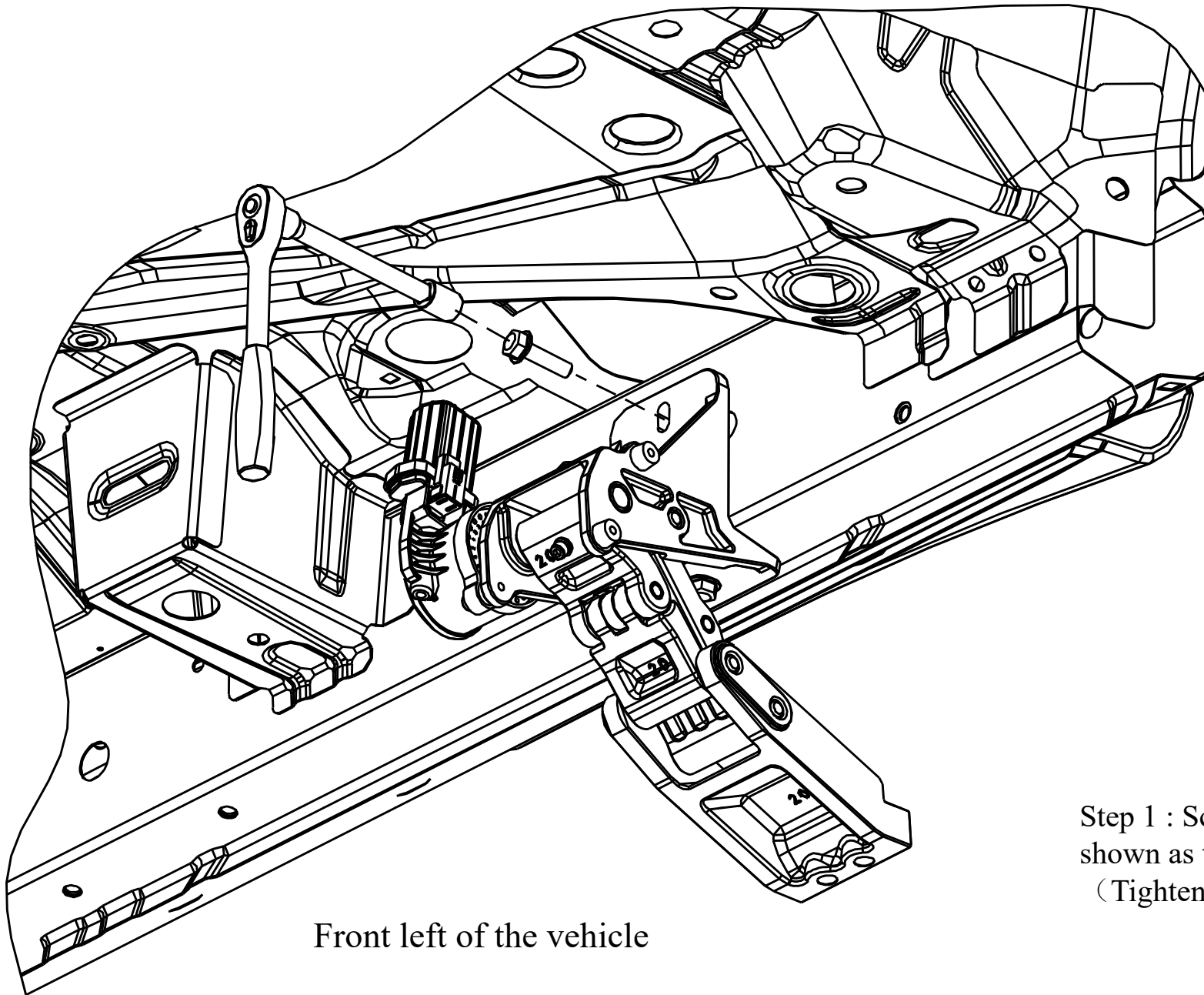

Front left of the vehicle

Step 1 : Screw the bolts in the holes shown as the picture ,then tighten them (Tighten torque is 35 Nm) .

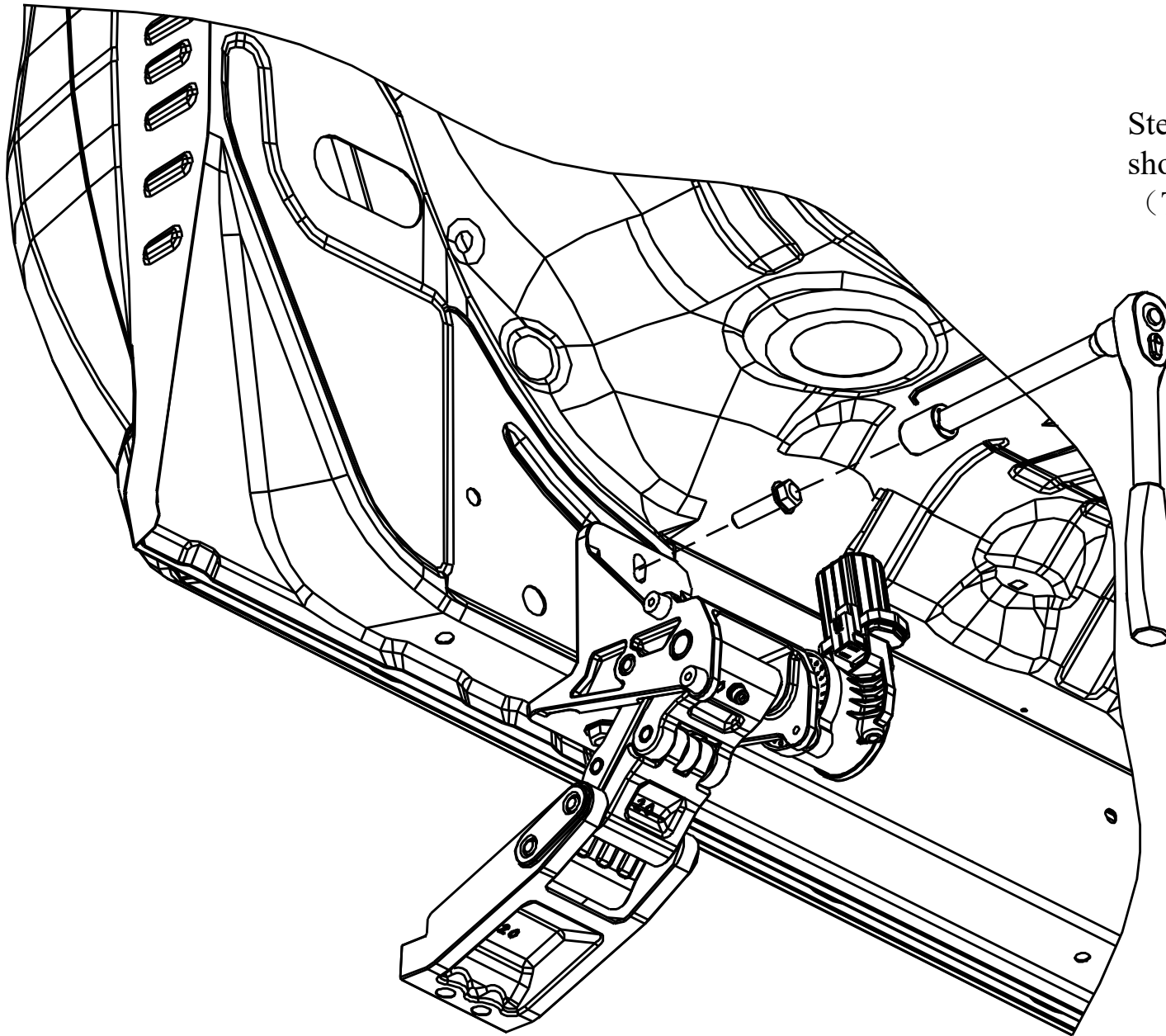

Step 2: Screw the bolts in the holes shown as the picture ,then tighten them (Tighten torque is 35 Nm) .

Rear left of the vehicle

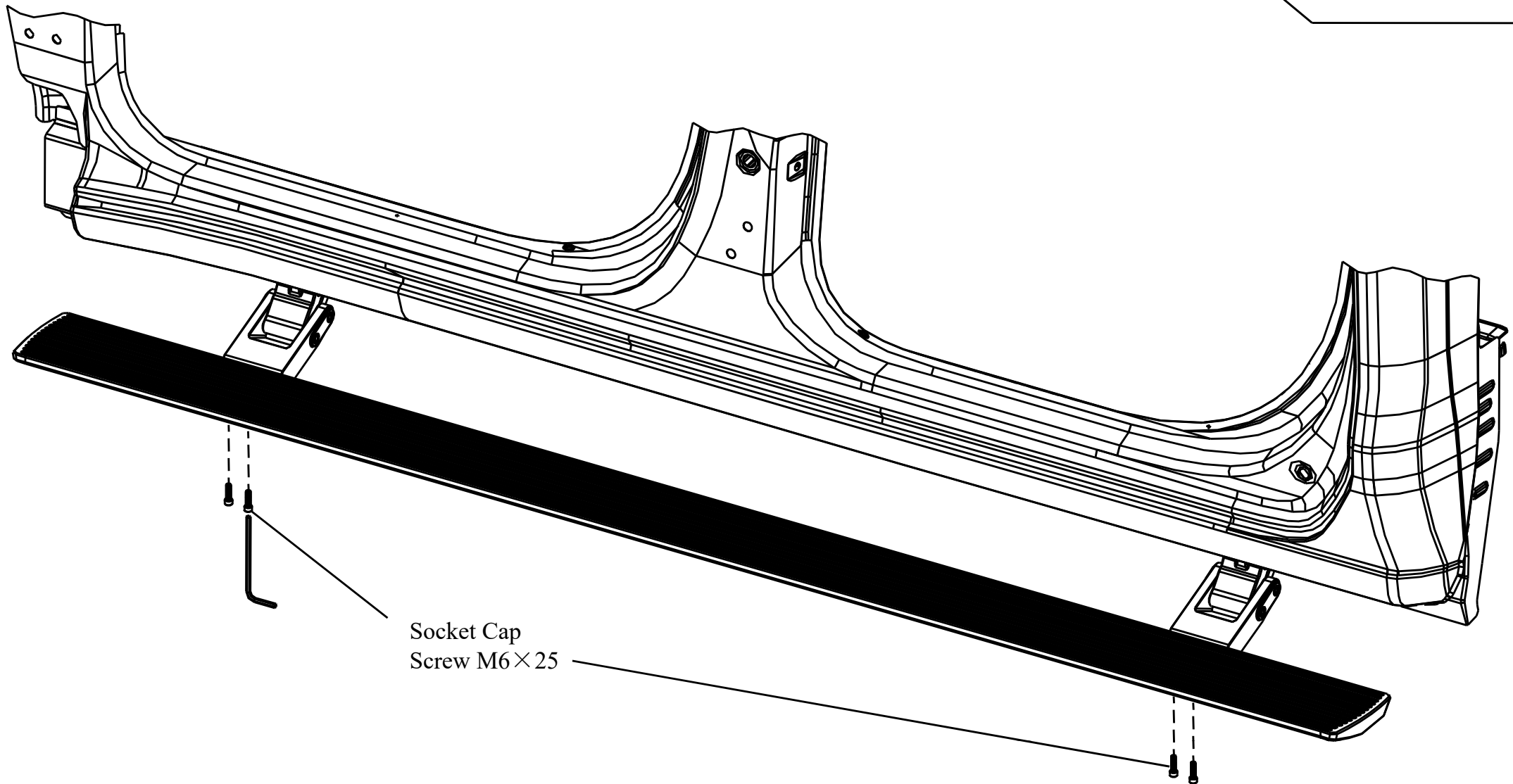

The installation of the right side for motor linkage and board is referenced to the left side.

Step 3: Install the board and adjust the T- nut to make the two end faces of the board reach to an appropriate position. Then use M6×25 socket cap screws for connecting and tightening (Tighten torque is 12Nm).

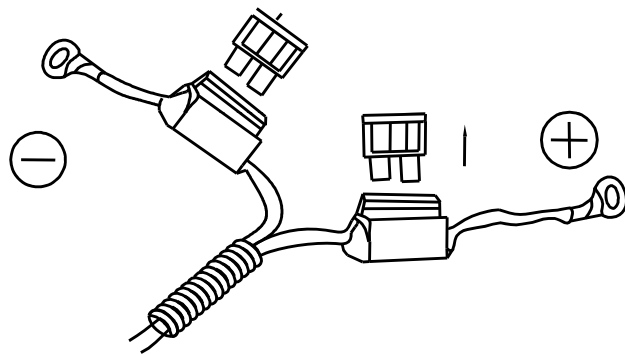
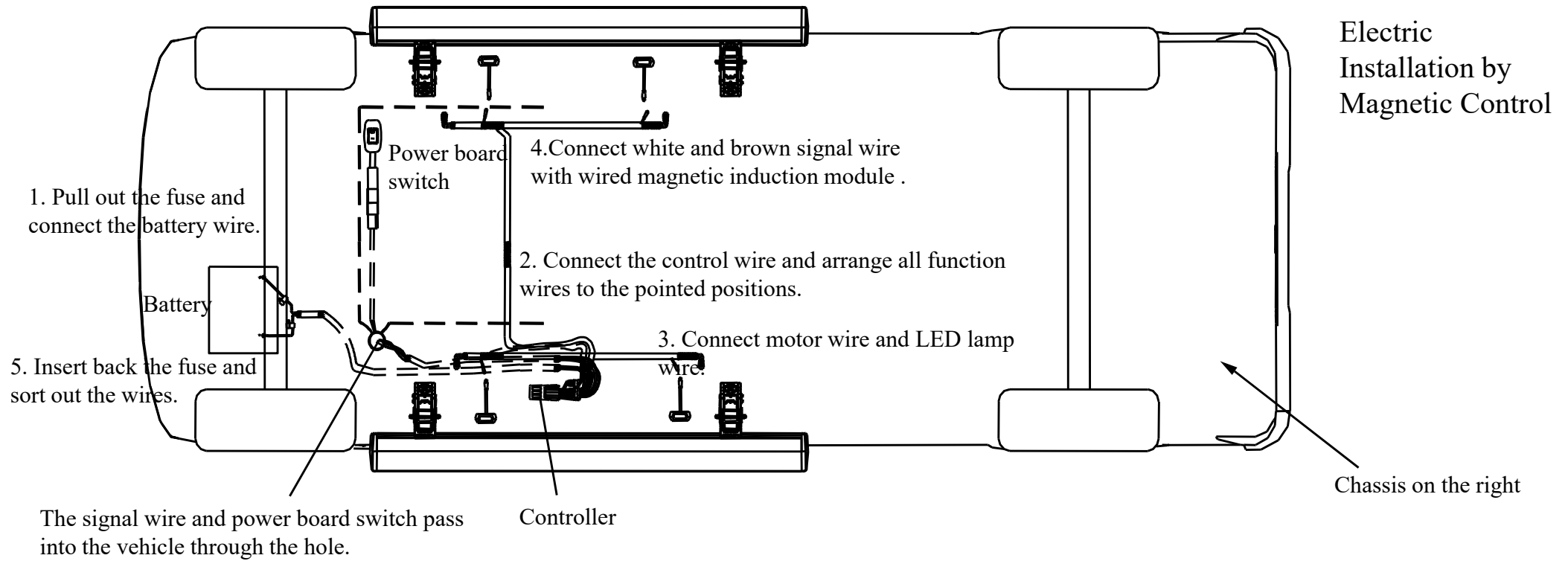

Step 1: Find out the control input wire and pull out the fuse (ensuring circuit safety during installation) and connect the positive and negative pole of wire harness to vehicle battery respectively.
Note: Control wire can not be modified privately.

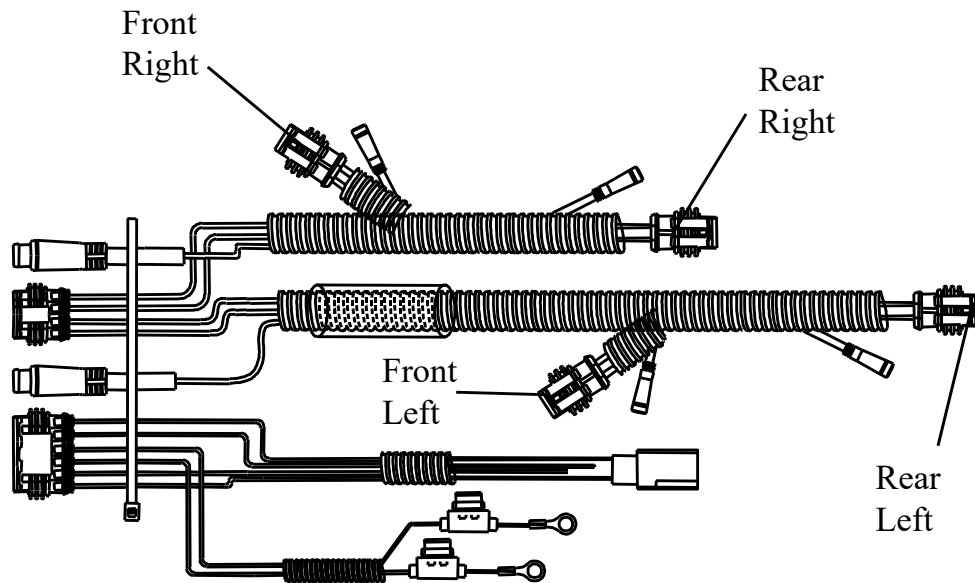

Figure 1

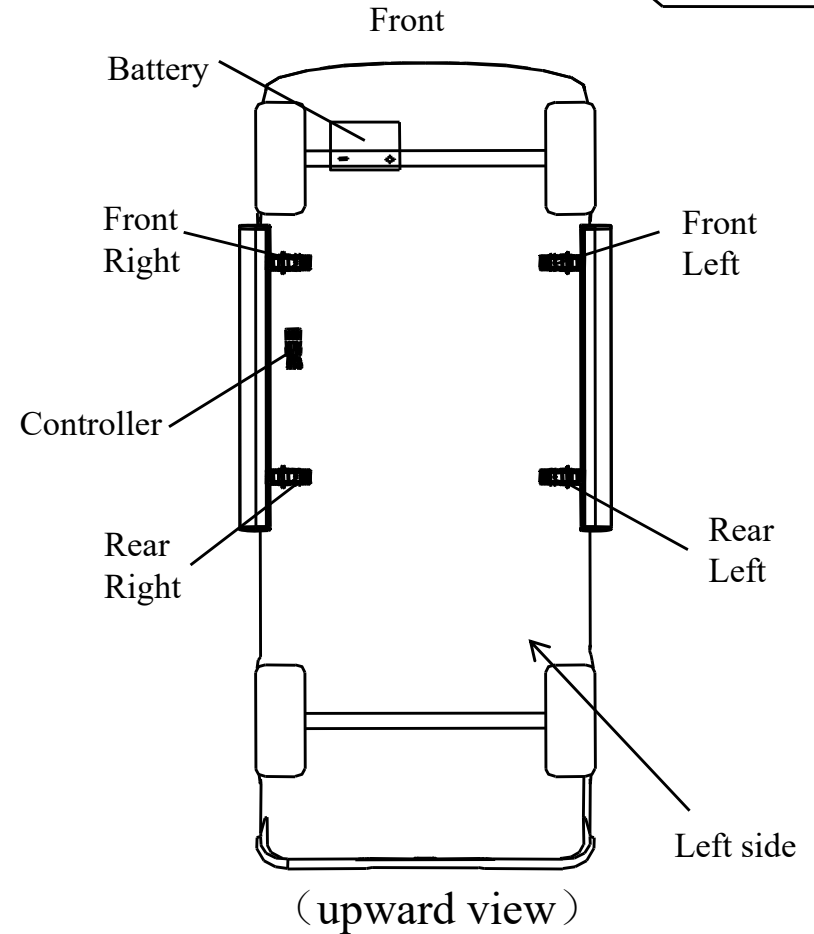
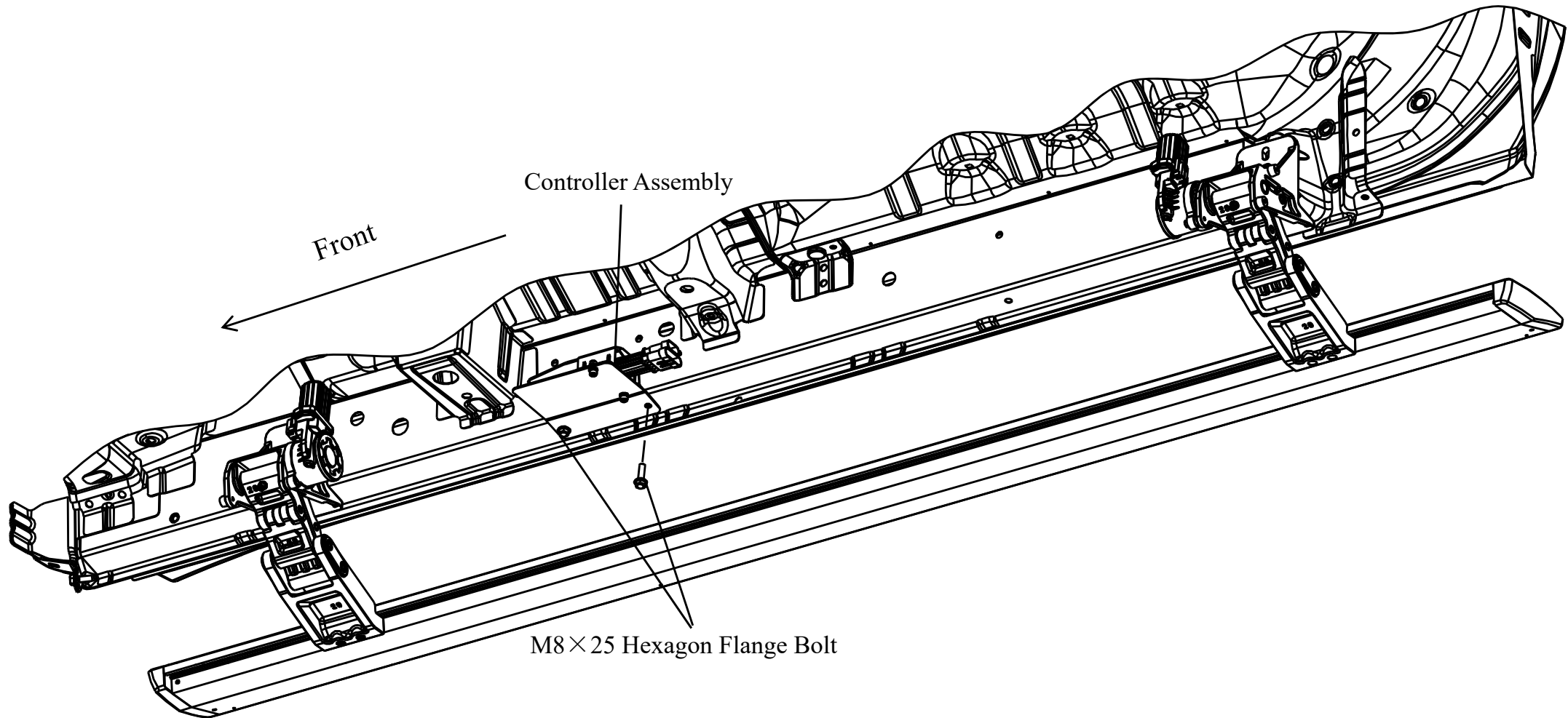
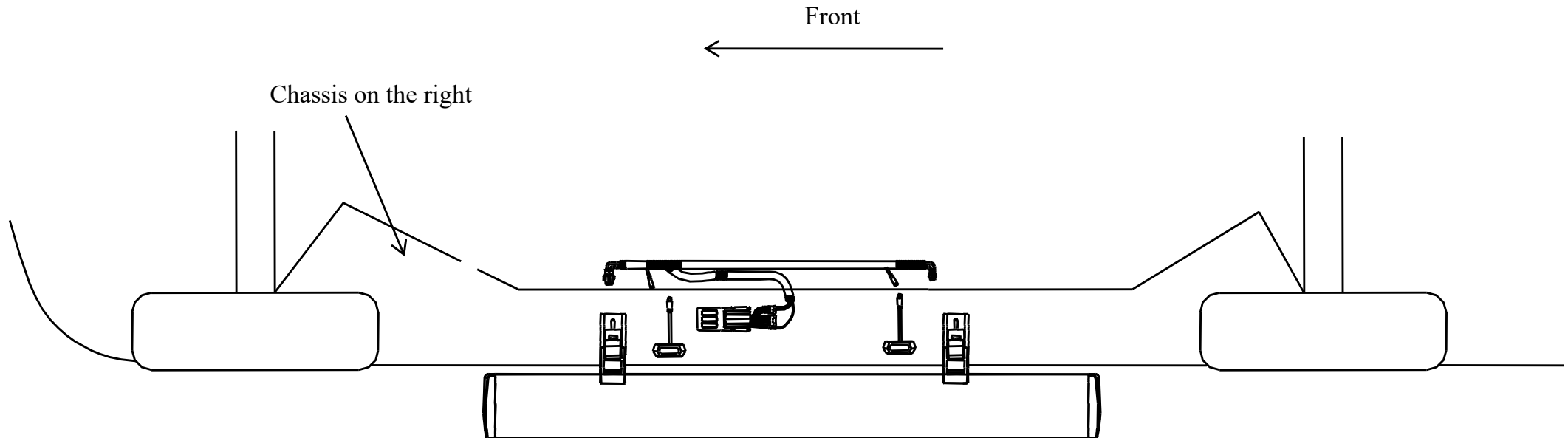

Figure 2

Figure 1 is the wire harness diagram and figure 2 is the installation diagram. When install the wire harness, make sure the four connectors are connected with the four motor linkages by “front right, rear right, front left and rear left”.



Step2 : As shown in the picture, install the controller assembly by two M8×25 hexagon flange bolts, and tighten them (Tighten torque is 35Nm).



Step 3: The arrangement of motor wire: Arrange the motor connection wire along the beam as shown in the picture, the motor wire plug extends to motors of linkage. At least, adjust the wire harness to make sure it is tidy and beautiful.

The other side uses the same way for installation.

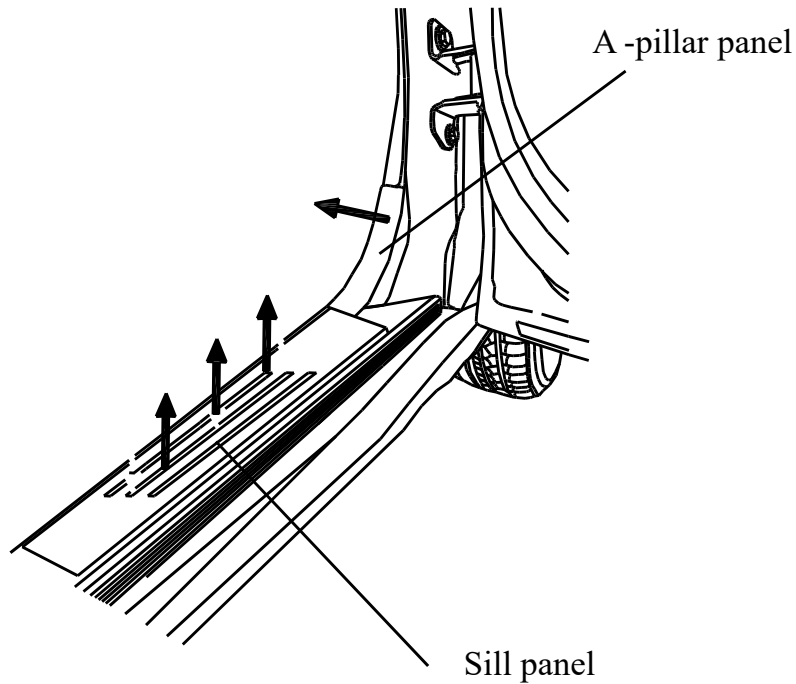
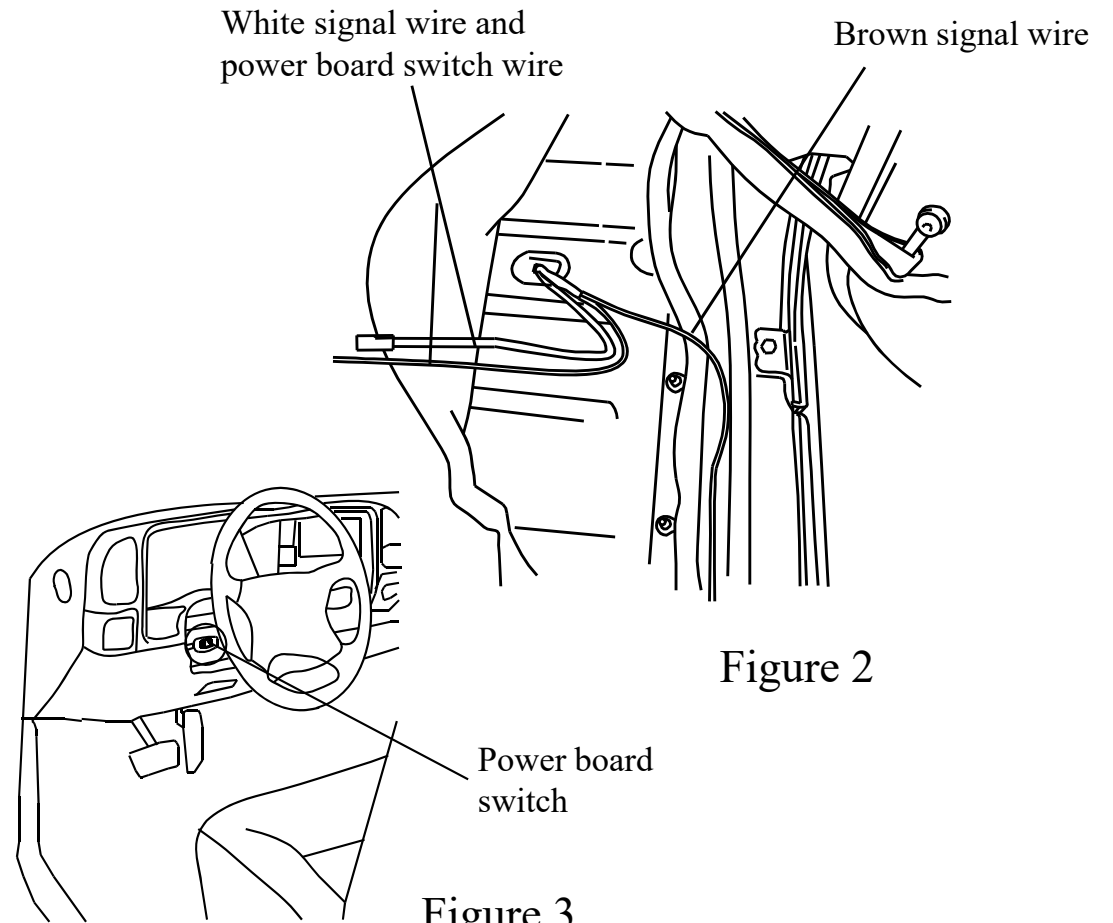
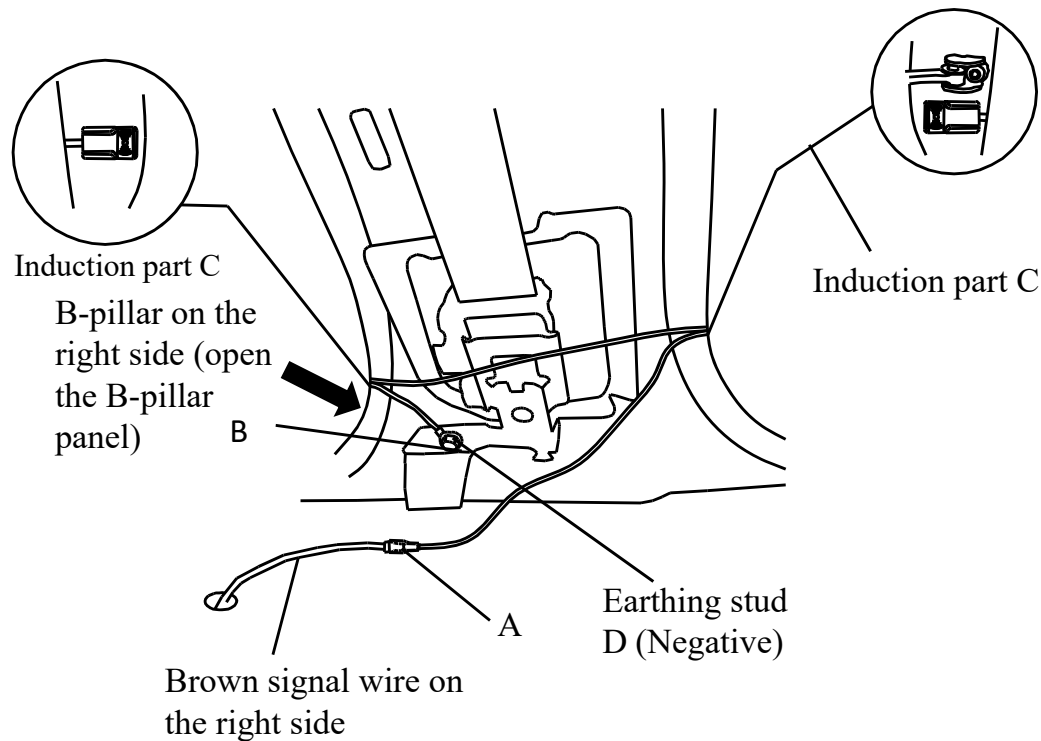

Figure 1



Step 4: Connection of signal wire: Pry the sill panel and A-pillar panel on the left above . Pull the brown signal wire into the vehicle through the rubber grommet of chassis on the right side. Then the white signal wire extends to the left side of the vehicle under the carpet, and stick the Power board switch to the left side under the steering wheel.

Magnetic Inductor Installation



Step 5: Open the B-pillar panel on the right side of the vehicle, expose the above part (as shown above), connect the brown signal wire to terminal A of magnetic inductor, loosen the earthing stud D, connect fork type terminal B to the earthing stud, and then tighten the earthing stud. Stick the induction part C to the both side of B-pillar, stick the magnet on the inside of vehicle door which is corresponding with induction part. The connection of white signal wire and wire harness induction on the left side are same with the installation of the right side.

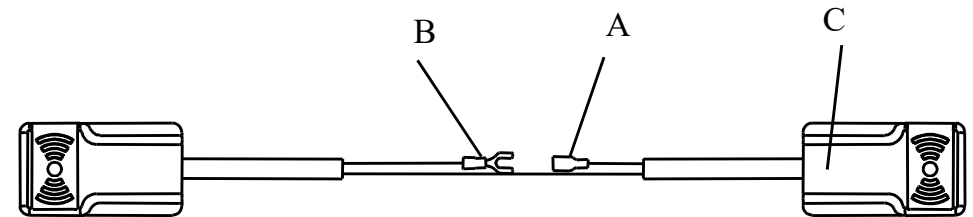

Wire Harness Magnetic Inductor

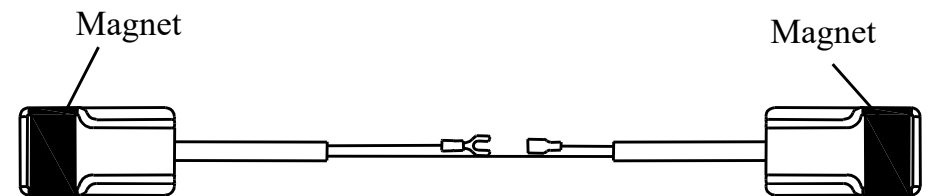
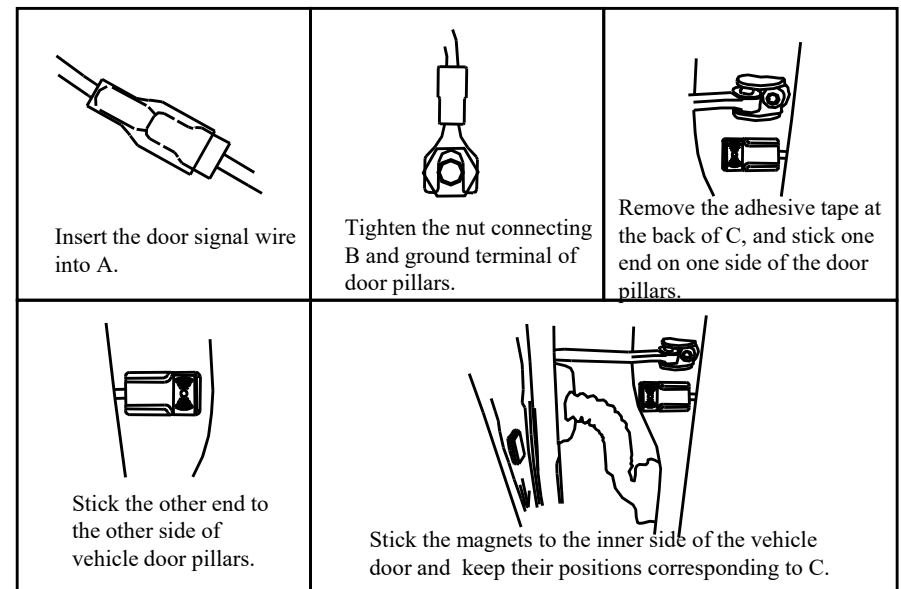

Instruction: The magnet position after closing the door is shown as above picture.

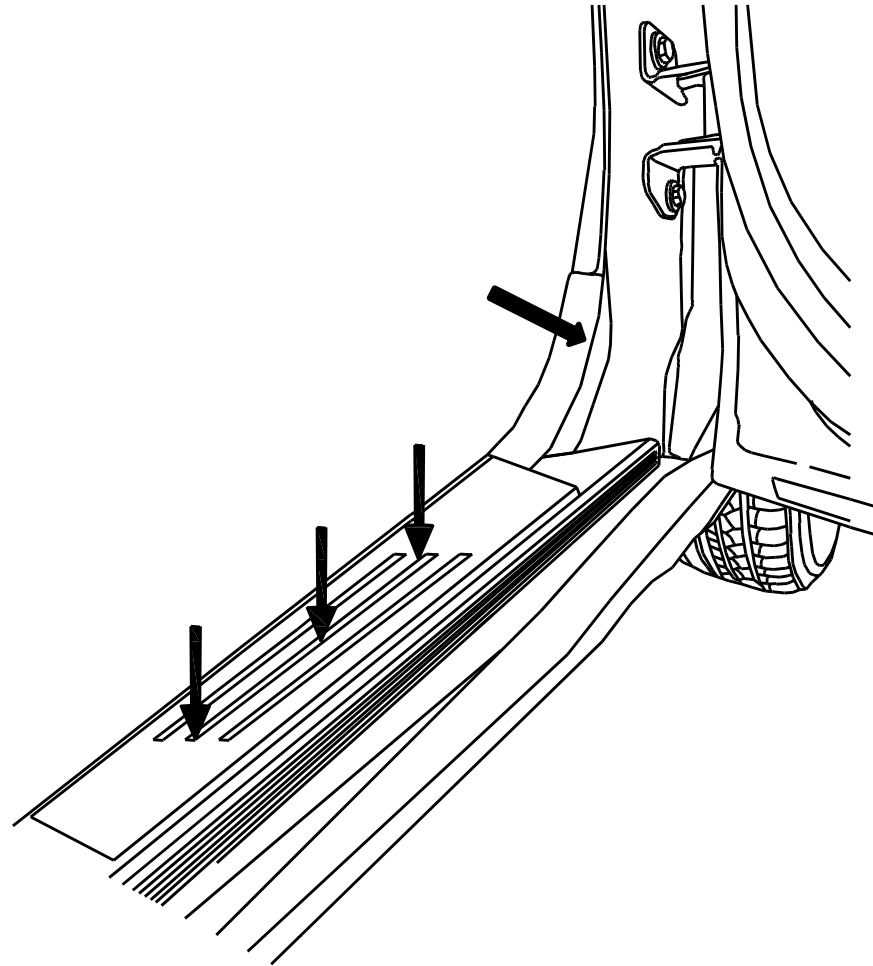

Step 6: Sort out the wire harness and close the panels. The installation of white signal wire on the left side is same with the right side .

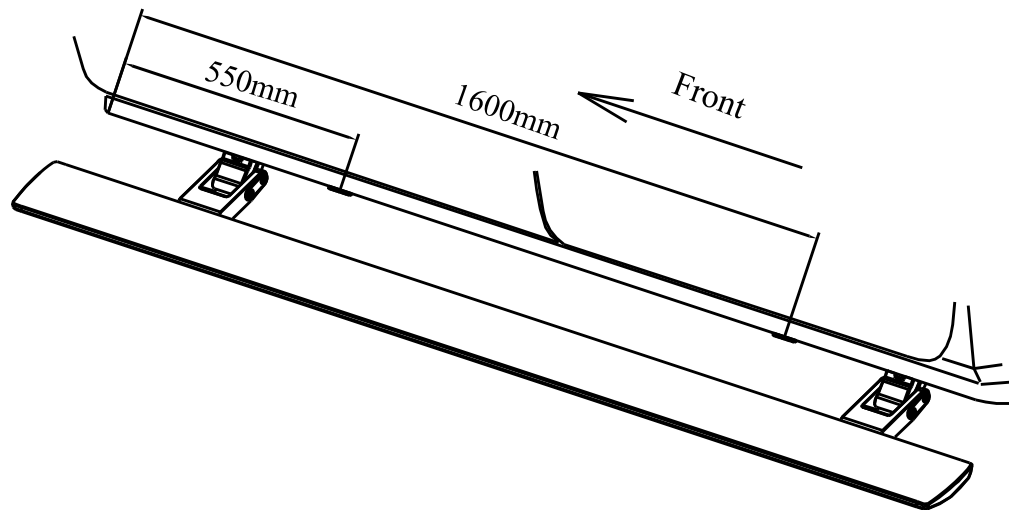

Step 7: Installation of LED lamp : Tear off the double-sided adhesive tape behind the LED lamp and stick it to the thin wall below the apron. The distance from designated pasting position of front and rear LED lamp to front door line of front door is shown as the picture (The distance of the front lamp is 550mm, and the rear lamp is 1600mm).

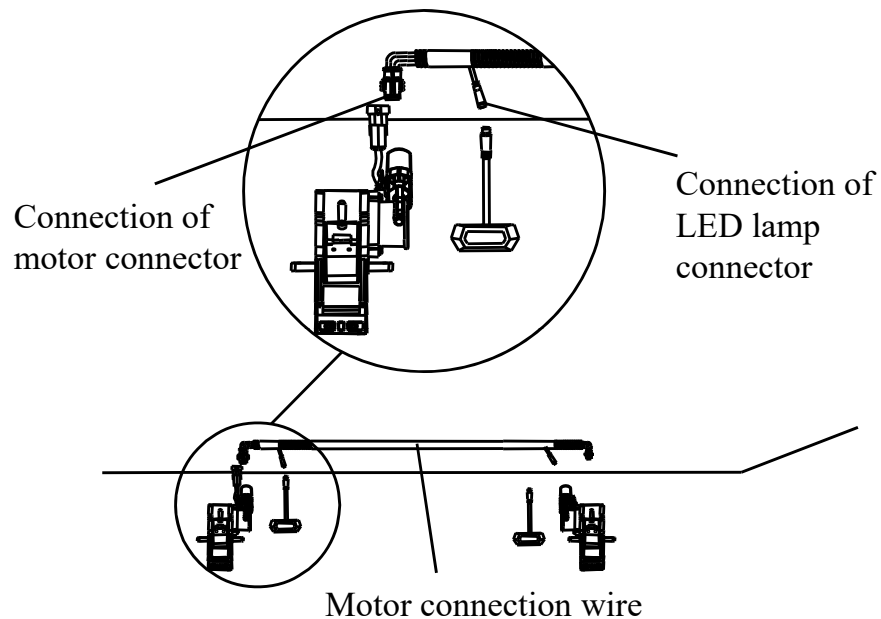

Step 8: Installation of motor wire: As shown in the picture, connect motor connector with the connector on motor wire. At the same time, connect the LED lamp with LED lamp connector on motor wire. Then fasten the wire harness on the vehicle beam by wire tie to make the wire harness neat. Same wire installation is for the other side.

Summary of Electric Part

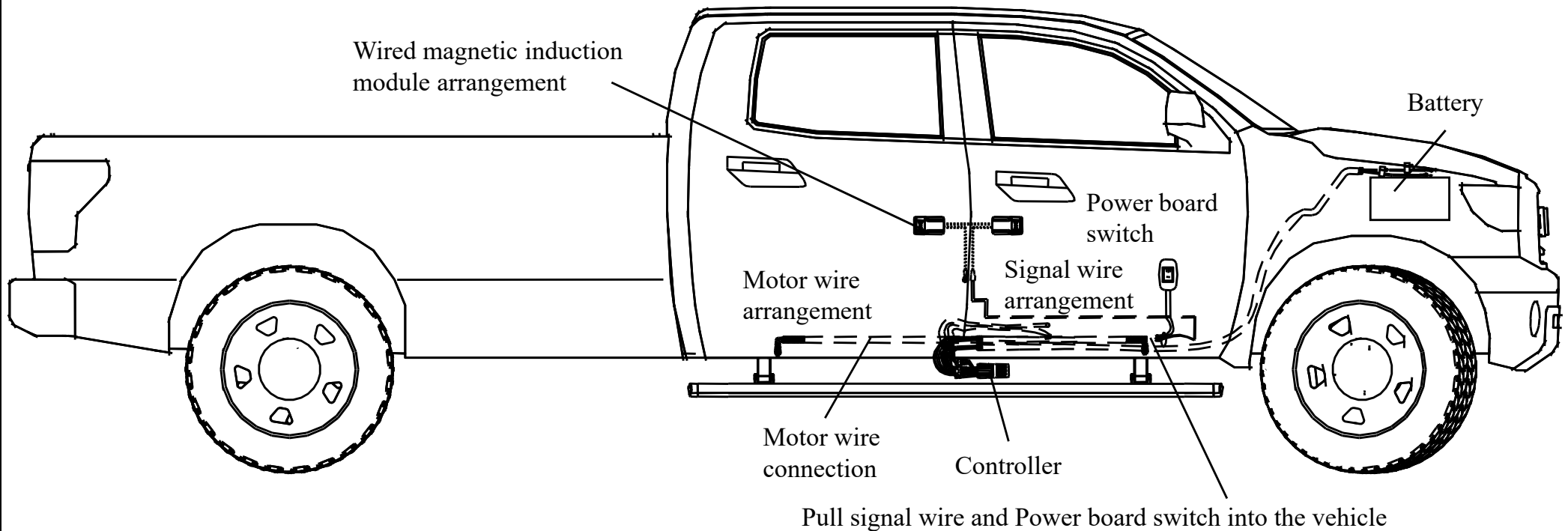

Step 9 : Check out the Power board switch of controller to make sure it is off. Insert back the fuse , arrange the wire harness in order. Check if all the wires are connected well and test if the power board can work normally . If it can work normally ,the board installation is completed. (If it can not work normally , please check the completeness of installation of each part.)

Instructions of Power Board Switch

Stick the power board switch with 3M tape under the left side of steering wheel.

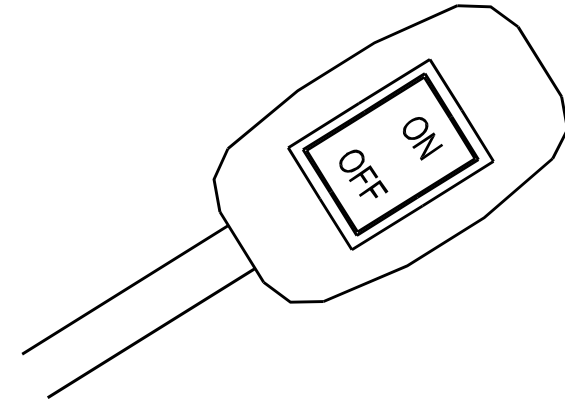
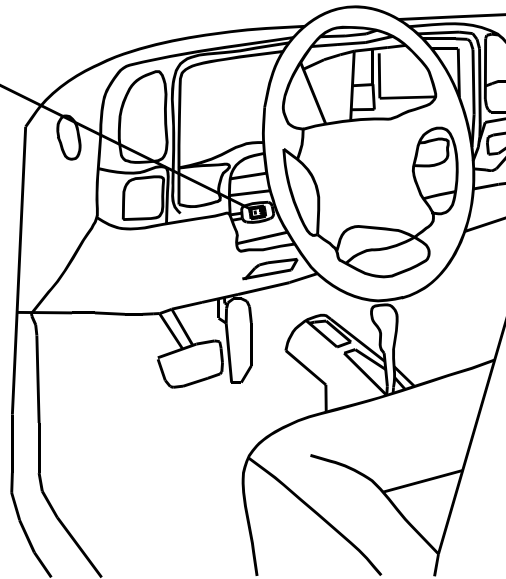

I. Function of power board switch

Turn off the switch when no need of power board or inconvenience of power board , then the power board will automatically get back and stop working to avoid any impact when use the vehicle .

II. Power board switch using method:

1. Press power board switch button to set “ON”.And at the same time, the power board will return to its normal working status.
2. Press the power board switch button to set “OFF”. And at the same time, the steps will automatically go back and stop working.

Maintenance		
3 months Periodical Inspection	Inspect the normal operation of the mechanism.	
	Inspect damage for each wire connection and the bare part outside of the vehicle beam.	
	Inspect screw's looseness of motor and power board .	
Special Case Inspection	Clean the sediment on time for power board and the linkages.	
	Clean the ice on time for power board and the linkages.	
Maintenance card		
The power board couldn't work normally when doors open and close	Electrical Malfunction	Fault connection of battery cable: recheck if you swap the battery's poles over, and if the fuse burns out.
		Fault connection of motor wire: recheck if all plugs are connected well.
		Fault connection of vehicle door control signal : recheck the connection of wires according to the diagram.
		Fault of controller: if there is no problem for all wires, please contact with our after sale service center.
	Mechanics Malfunction	An object is blocking the board.
		The two installation surfaces are not at the same level.

Note: In the using process , you may meet some other unknown trouble. Please contact us timely to feedback the problems , we will solve them for you as soon as possible. Thank you!

T-MAX Product Warranty Instructions

Thank you very much for choosing our product!

I Maintenance Instruction

- 1、 During warranty period, T-MAX provides free maintenance for any malfunction related to the manufacturer. Warranty period lasts 24 months or 5 kilo in 2 years after sale. For individual related faults, T-MAX provides paid maintenance.
- 2、 T-MAX promises to provide lifetime maintenance for Way Past Warranty and only charges for necessary material and labor. The charging standard refers to the ATM fee scale of local T-MAX terminal service provider.
- 3、 For all replaced parts, T-MAX ensures to provide maintenance within 12 months after the replacement.
- 4、 The ownership of the old parts from the replacement belongs to T-MAX (Hangzhou) Technology Co., Ltd.
- 5、 Within the limit of law, the interpretation of warranty policy belongs to T-MAX (Hangzhou) Technology Co., Ltd.

II Situations below will not offer free warranty:

- 1、 No warranty certificate;
- 2、 Fault caused by customer's misusing or Incorrect installation
- 3、 Fault caused by none professional maintenance staff's disassembly
- 4、 Fault caused by force majeure.
- 5、 Fault, scratch and torn due to movement or falling
- 6、 Fault caused by improper maintenance or misusing

III Precautions:

- 1、 In the case of extreme off-road, electric pedal is not recommended to avoid the damage of the pedal;
- 2、 After extreme off-road, start maintenance for electric pedal to protect the performance and the longevity of the pedal;
- 3、 Electrical parts: Check the control lines in T-MAX Terminal Services branch regularly;
- 4、 Mechanical parts: Pedal and pedal components should be cleaned up promptly when sediment appears;
- 5、 Power board should be using frequently. The idle time should not exceed three months;
- 6、 Power board need maintenance regularly in T-MAX terminal service branch;

Warranty card

Product Type		User Name	
Product Name		Tel	
Factory Number		Address	
Date of Purchase			
Purchase Shop			

- 7、Forbidding high temperature when using the power board;
- 8、The heads of both sides of the single pedal are made of plastic. They are pedal's exterior decorating parts. Do not board;
- 9、Do not put thick mats or other debris on power board to avoid the danger of wrong stripping on the pedal;
- 10、After initial installation, please pay attention to check for looseness. Tighten screws if necessary. Usually after 3-5 times retractable rear door switch pedal in place, the power board could be fixed finally and checked regularly;

11、How to exclude unexpected failures of power board?

The board couldn't activate when doors open and close

① Electrical fault: the connection point and line failure, the gate control trigger line failure, controller failure, the electrical motor cable failure, motor failure; send to local T-MAX Terminal Services branch to detect and repair.

② Mechanical faults: a foreign object obstruction pedal movement, the installation of two pedal mounting surfaces is not at the same level; send to local T-MAX Terminal Services branch to detect and repair. Pedal when the door is reflected insensitively。

Gate control signal is error. Send to local T-MAX Terminal Services branch to check the wiring according to the control wiring diagram.

Maintenance records

Date	Fault Description	Fault Reasons	Result	Note

E-BOARD[®]

Produced by
T-MAX(HANGZHOU)TECHNOLOGY CO.,LTD

www.tmax.biz